



SPRAYMASTER® EP-50 PLURAL COMPONENT SPRAYER



**BUILT MARCO
TOUGH**
MARCO MANUFACTURED

PART NUMBERS AND SCHEMATICS GUIDE

Company Profile

Since 1944, Marco has developed a strong tradition of providing innovative and reliable products and services to the surface preparation and protective coatings industries. We are the world's premier provider of Abrasives, Blasting, Coating, Dust Collectors, Engineered Systems, Rental, Safety, Service, Repair, & Modernization, and Vacuums.

Through innovative designs and a total commitment to quality, Marco manufactures products that increase production rates, create a safer workplace, and reduce maintenance costs. Marco's industry experience, manufacturing capabilities, legendary customer service, product availability, logistics services, and technology leadership is your assurance that we deliver high quality products and services, providing the best value to you, our customer.

The Marco Difference

- **Industry Experience** – With Marco on your team, you have access to expertise which can only come from decades of industry leadership. We have organized our engineering department, production specialists, customer operations, and safety support into a “Center of Competence.” As a Marco customer, you have access to hundreds of years of cumulative experience related to your operations.
- **Manufacturing Excellence** – Marco is a U.S. based, ISO 9001:2008 certified manufacturer of equipment for the Surface Preparation and Protective Coatings industries. Marco's engineers benchmark the industry to ensure that we design and manufacture superior products that set the “Gold Standard” for performance, safety, and quality.
- **Legendary Customer Service** – Marco's legendary customer service team is staffed by friendly, highly-trained individuals who are focused on providing the highest level of product support, order accuracy, and customer satisfaction.
- **Product Availability** – We stock over 10,000 SKU's and have more than 45 shipping locations to serve North American and International markets for all major brands of blasting and coating equipment. As the largest provider of surface preparation and protective coatings equipment in the world, our inventory levels and product availability are unmatched.
- **Logistics Services** – Marco's in-house logistics team is dedicated to moving your shipment anywhere in the world. We move more than 14,000 truckloads every year, allowing you to save on freight costs by leveraging our buying power. Lower your process costs with a single invoice, which includes product and freight.
- **Technology Leadership** – Our website provides: Operator's Manuals, Part Numbers and Schematics Guides, SDS information, and Features & Specifications Guides, providing access to information 24/7. Our Extranet application allows you to receive quotes and place orders online. Our Intranet maintains a complete record of your purchase history to assist with ongoing support of your existing equipment and future purchasing decisions.

Vision Statement

Marco is the world's premier provider of Abrasives, Blasting, Coating, Dust Collectors, Engineered Systems, Rental, Safety, Service, Repair, & Modernization, and Vacuums.

Mission Statement

Marco provides strong leadership and innovation to the surface preparation and protective coatings industries. We dedicate our efforts to the continuous improvement of our products, services, processes, people, and most importantly, the quality of our customer's experience.

Quality Statement

Marco is committed to providing superior quality in the design, manufacturing, distribution, rental, service, and repair of our products. Our ISO 9001:2008 certification extends throughout all operations in all locations. Continuous improvement of our processes and supply chain Integration comprise the core of our business strategy for delivering exceptional quality and value in all Marco products and services.

Management Philosophy

We are a company dedicated to the success of every customer and associate. We discuss, debate, challenge, measure, and test our ideas. We will be boundless and limitless in our passion to improve. Through sound leadership and dedicated associates, we will ensure a long term, profitable future for Marco, our associates, customers, and suppliers.

TABLE OF CONTENTS

Company Profile	2
Part Numbers	4
Part Numbers And Schematics Guide	6
Spraymaster® EP 50:1 240-Volt AC General Purpose – Skid	6
Spraymaster® EP 50:1 240-Volt AC Hazardous Location – Skid	8
Spraymaster® EP 50:1 480-Volt AC General Purpose – Skid	10
Spraymaster® EP 50:1 480-Volt AC Hazardous Location – Skid	12
Spraymaster® EP 50:1 240-Volt AC General Purpose – Short Skid	14
Spraymaster® EP 50:1 240-Volt AC Hazardous Location – Short Skid	16
Spraymaster® EP 50:1 480-Volt AC General Purpose – Short Skid	18
Spraymaster® EP 50:1 480-Volt AC Hazardous Location – Short Skid	20
Spraymaster® EP 50:1 240-Volt AC General Purpose – Cart	22
Spraymaster® EP 50:1 240-Volt AC Hazardous Location – Cart	24
Spraymaster® EP 50:1 480-Volt AC General Purpose – Cart	26
Spraymaster® EP 50:1 480-Volt AC Hazardous Location – Cart	28
Spraymaster® EP-50 Air Motor & Lower Pump Assembly	30
Air Manifold Assembly	32
Wheel Kit	34
General Duty Control Box	36
Hazardous Location Control Box	38
Air-In Manifold Assembly	40
Optional Accessories	42

PART NUMBERS

SPRAYMASTER® EP-50 PLURAL COMPONENT SPRAYER - SKID MOUNT

Part Numbers	Power Source	Hazardous Location	Spraymaster® 25 Gallon Round Component Tanks	Graco® XM50™ Bare Sprayer	Dosing Valves	Graco® 45:1 Merkur® Solvent Flush Pump
20101041	240-Volt AC	X	X	1:1 – 10:1	X	X
20100992	240-Volt AC		X	1:1 – 10:1	X	X
20100983	480-Volt AC	X	X	1:1 – 10:1	X	X
20101042	480-Volt AC		X	1:1 – 10:1	X	X

SPRAYMASTER® EP-50 PLURAL COMPONENT SPRAYER - SHORT SKID MOUNT

Part Numbers	Power Source	Hazardous Location	Spraymaster® 25 Gallon Round Component Tanks	Graco® XM50™ Bare Sprayer	Dosing Valves	Graco® 45:1 Merkur® Solvent Flush Pump
20101145	240-Volt AC	X		1:1 – 10:1	X	X
20101144	240-Volt AC			1:1 – 10:1	X	X
20100528	480-Volt AC	X		1:1 – 10:1	X	X
20100676	480-Volt AC			1:1 – 10:1	X	X

SPRAYMASTER® EP-50 PLURAL COMPONENT SPRAYER - CART MOUNT

Part Numbers	Power Source	Hazardous Location	Spraymaster® 25 Gallon Round Component Tanks	Graco® XM50™ Bare Sprayer	Dosing Valves	Graco® 45:1 Merkur® Solvent Flush Pump
20101139	240-Volt AC	X	X	1:1 – 10:1	X	X
20101137	240-Volt AC		X	1:1 – 10:1	X	X
20101140	480-Volt AC	X	X	1:1 – 10:1	X	X
20101138	480-Volt AC		X	1:1 – 10:1	X	X

PART NUMBERS

Spraymaster® EP-50 Plural Component Sprayer – Skid Mount

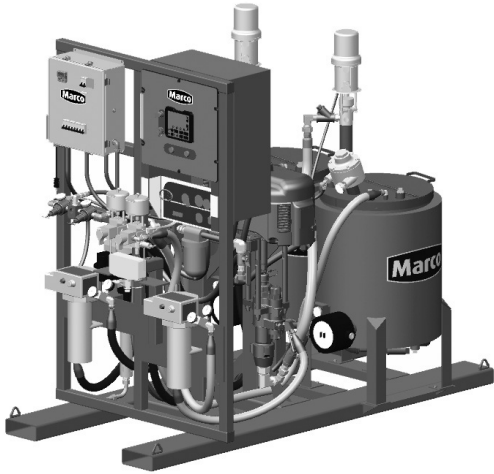

General Purpose



Hazardous Location

Spraymaster® EP-50 Plural Component Sprayer – Short Skid Mount

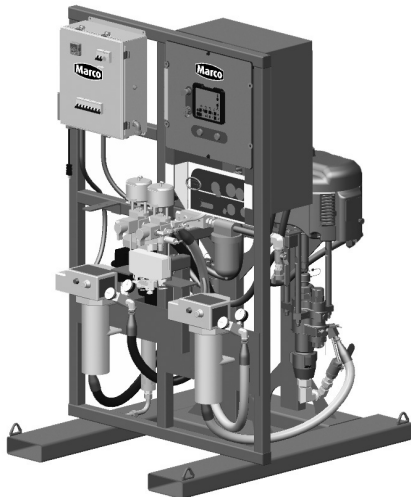

General Purpose

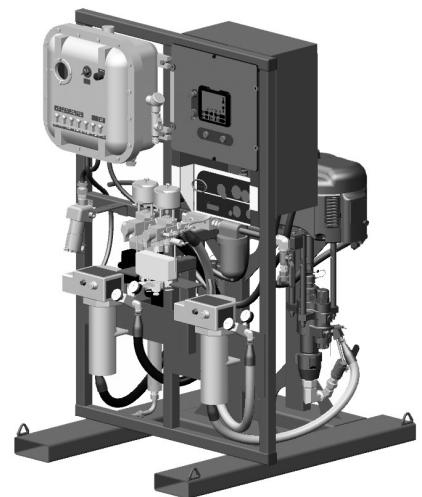

Hazardous Location

Spraymaster® EP-50 Plural Component Sprayer – Cart Mount



General Purpose



Hazardous Location

PART NUMBERS AND SCHEMATICS GUIDE

Spraymaster® EP 50:1 240-Volt AC General Purpose – Skid

Item #	Part #	Description
Fig. 1		
—	20100992	Spraymaster® EP 50:1 240-Volt AC General Purpose – Skid
1	20G255771	Control Box
2	—	Air Motor and Lower Pump Assembly <i>(See Fig. 13)</i>
3	20101081	Spraymaster® 25 Gallon Heated Coatings Tank – Complete <i>(Two Required)</i>
4	—	Air-In Manifold Assembly <i>(See Fig. 18)</i>
5	10ME1	3/4" NPT (M) Coupling – 2-lug
6	20100195	3/8-16 x 1" Zinc Bolt <i>(Eight Required)</i>
7	20100138	3/8-16 Hex Lock Nut Zinc <i>(12 Required)</i>
8	10102331	3/8" SAE Flat Washer Zinc <i>(12 Required)</i>
9	20100103	Dosing Manifold Bracket
10	20G255684	Mix Manifold
11	20G245869	In-line Paint Heater <i>(Two Required)</i>
12	20G262393	Flush Pump
13	20G255478	Dose Valve <i>(Two Required)</i>
14	—	Air Manifold Assembly <i>(See Fig. 14)</i>
15	20100072	Electrical Box <i>(See Fig. 16)</i>
16	20100921	Round Tank Frame – Skid
17	20100284	Flush Pump Mounting Bracket
18	20100125	1/4-20 x 3/4" Zinc Bolt <i>(Four Required)</i>
19	1012153	1/4" Lock Washer <i>(Four Required)</i>
—	20TAH100312	Static Mixer 3/8" Diameter x 12 <i>(Two Required) (Not Shown)</i>
—	20BEAKER1000ML	1000 Milliliter Test Beaker
—	2091000	Hazard Decals
—	20100564	Liquid Level Control Sensor Kit – Optional

PART NUMBERS AND SCHEMATICS GUIDE

Figure 1: Spraymaster® EP 50:1 240-Volt AC General Purpose – Skid

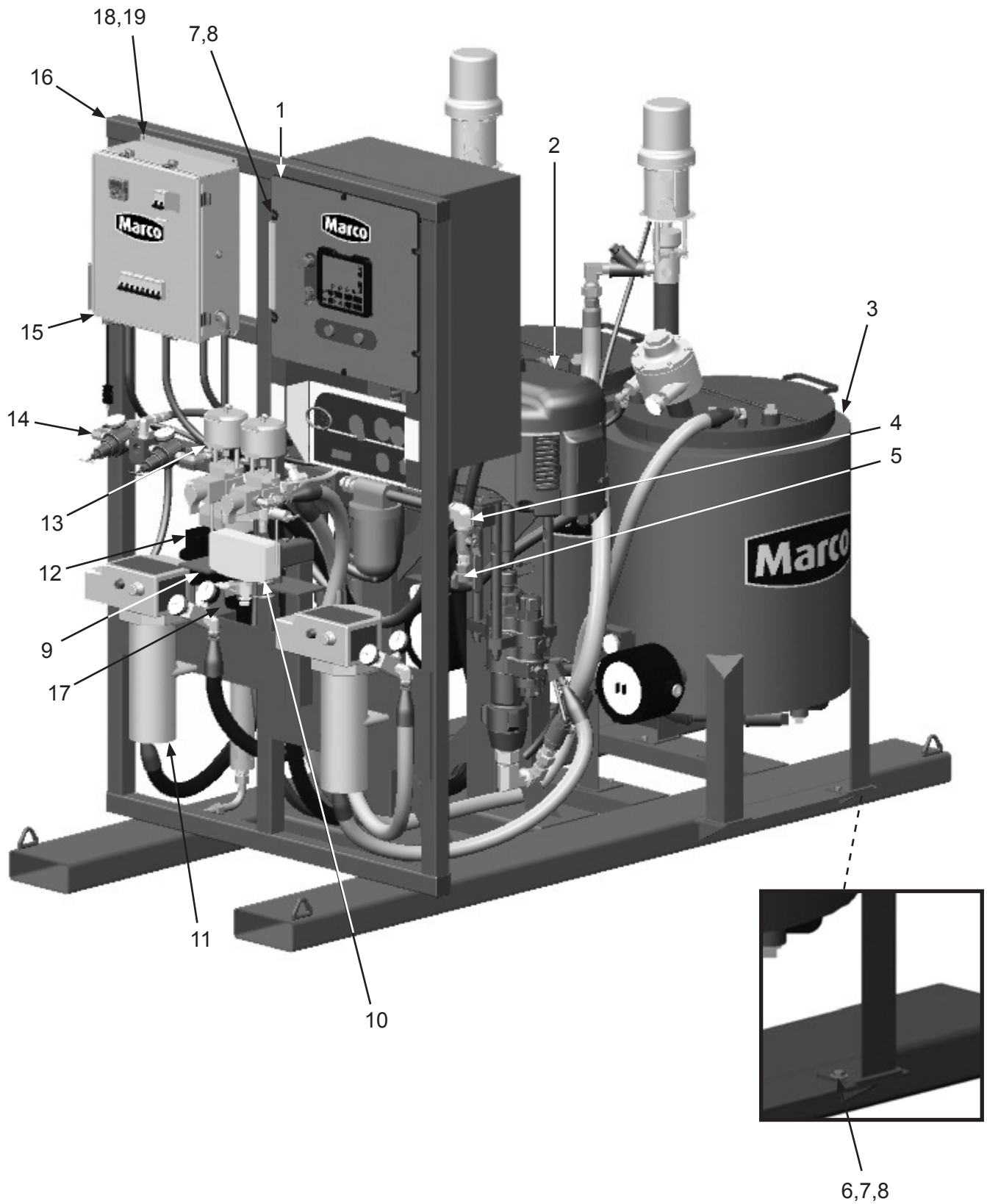

PART NUMBERS AND SCHEMATICS GUIDE

Spraymaster® EP 50:1 240-Volt AC Hazardous Location – Skid

Item #	Part #	Description
Fig. 2		
—	20101041	Spraymaster® EP 50:1 240-Volt AC Hazardous Location – Skid
1	20G255771	Control Box
2	—	Air Motor and Lower Pump Assembly (<i>See Fig. 13</i>)
3	20101081	Spraymaster® 25 Gallon Heated Coatings Tank – Complete (<i>Two Required</i>)
4	—	Air-In Manifold Assembly (<i>See Fig. 18</i>)
5	10ME1	3/4" NPT (M) Coupling – 2-lug
6	20100195	3/8-16 x 1" Zinc Bolt (<i>Eight Required</i>)
7	20100138	3/8-16 Hex Lock Nut Zinc (<i>12 Required</i>)
8	10102331	3/8" SAE Flat Washer Zinc (<i>12 Required</i>)
9	20100284	Flush Pump Mounting Bracket
10	20G255684	Mix Manifold
11	20G245869	In-line Paint Heater (<i>Two Required</i>)
12	20G262393	Flush Pump
13	20100279	30 AMP Receptacle
14	20G255478	Dose Valve (<i>Two Required</i>)
15	—	Air Manifold Assembly (<i>See Fig. 14</i>)
16	20MXPXCE161606N4	Hazardous Duty Distribution Panel (<i>See Fig. 17</i>)
17	20100921	Round Tank Frame
18	20100103	Dosing Manifold Bracket
—	20TAH100312	Static Mixer 3/8" Diameter x 12 (<i>Two Required</i>) (<i>Not Shown</i>)
—	20BEAKER1000ML	1000 Milliliter Test Beaker
—	2091000	Hazard Decals
—	20100564	Liquid Level Control Sensor Kit - Optional

PART NUMBERS AND SCHEMATICS GUIDE

Figure 2: Spraymaster® EP 50:1 240-Volt AC Hazardous Location – Skid

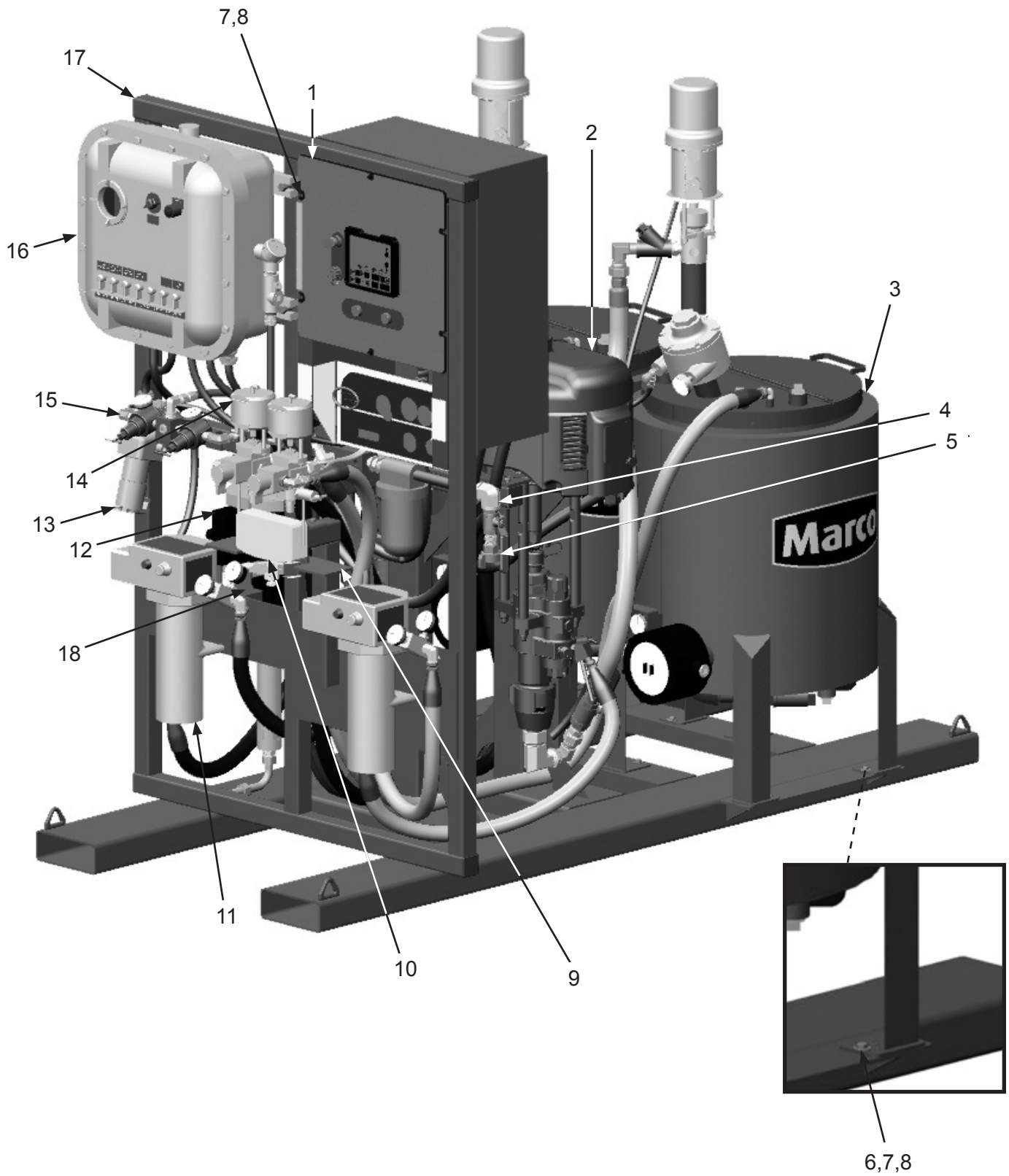

PART NUMBERS AND SCHEMATICS GUIDE

Spraymaster® EP 50:1 480-Volt AC General Purpose – Skid

Item #	Part #	Description
Fig. 3		
—	20101042	Spraymaster® EP 50:1 480-Volt AC General Purpose – Skid
1	20G255771	Control Box
2	—	Air Motor and Lower Pump Assembly (<i>See Fig. 13</i>)
3	20101082	Spraymaster® 25 Gallon Heated Coatings Tank – Complete (<i>Two Required</i>)
4	—	Air-In Manifold Assembly (<i>See Fig. 18</i>)
5	10ME1	3/4" NPT (M) Coupling – 2-lug
6	20100195	3/8-16 x 1" Zinc Bolt (<i>Eight Required</i>)
7	20100138	3/8-16 Hex Lock Nut Zinc (<i>12 Required</i>)
8	10102331	3/8" SAE Flat Washer Zinc (<i>12 Required</i>)
9	20100284	Flush Pump Mounting Bracket
10	20100287	7.5 Kva Transformer
11	20G255684	Mix Manifold
12	20G245864	In-line Paint Heater (<i>Two Required</i>)
13	20G262393	Flush Pump
14	20G255478	Dose Valve (<i>Two Required</i>)
15	—	Air Manifold Assembly (<i>See Fig. 14</i>)
16	20000051	Electrical Box (<i>See Fig. 16</i>)
17	20100921	Round Tank Frame – Skid
18	20100103	Dosing Manifold Bracket
19	20100125	1/4-20 x 3/4" Zinc Bolt (<i>Four Required</i>)
20	1012153	1/4" Lock Washer (<i>Four Required</i>)
—	20TAH100312	Static Mixer 3/8" Diameter x 12 (<i>Two Required</i>) (<i>Not Shown</i>)
—	20BEAKER1000ML	1000 Milliliter Test Beaker
—	2091000	Hazard Decals
—	20100564	Liquid Level Control Sensor Kit – Optional

PART NUMBERS AND SCHEMATICS GUIDE

Figure 3: Spraymaster® EP 50:1 480-Volt AC General Purpose – Skid

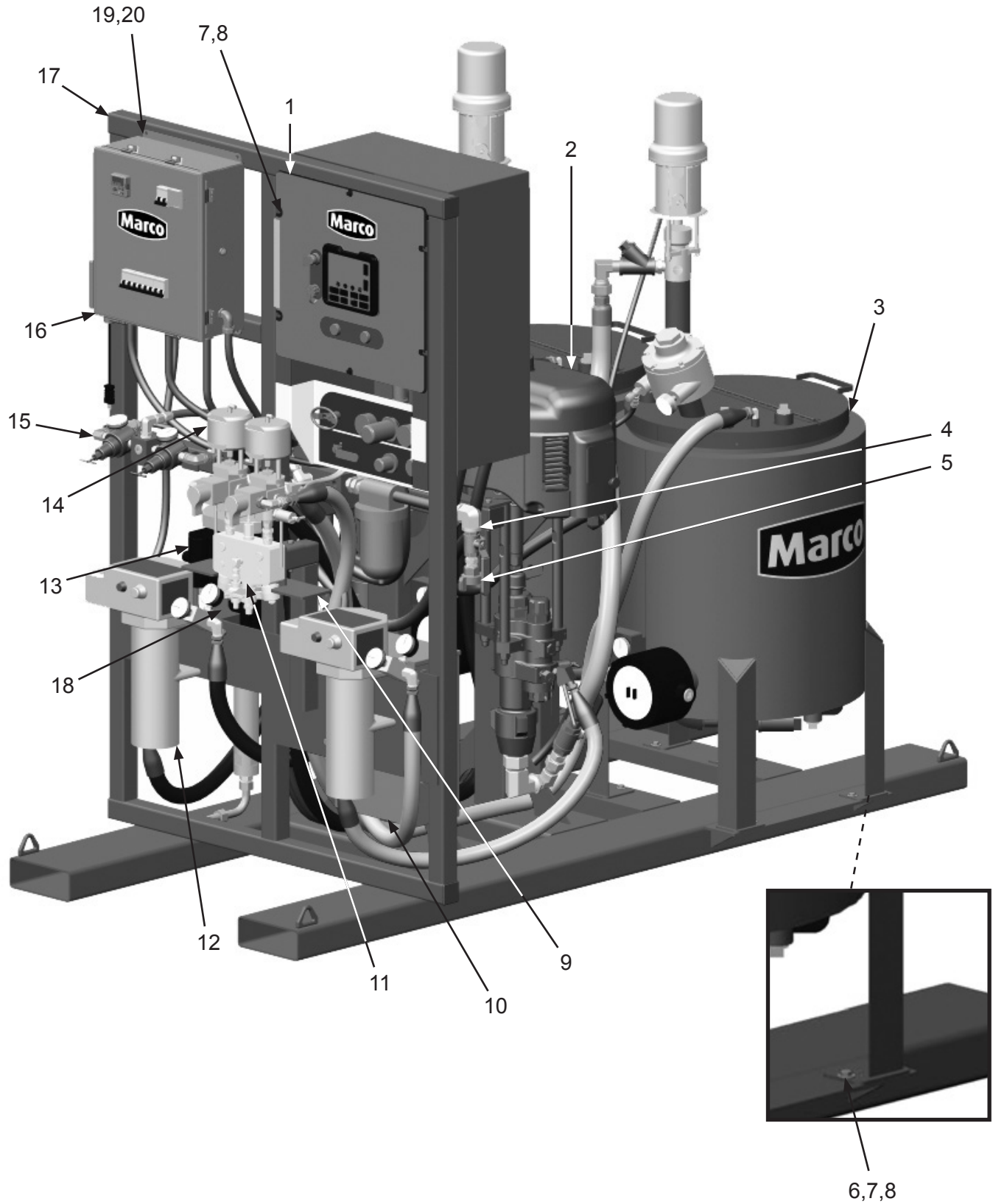

PART NUMBERS AND SCHEMATICS GUIDE

Spraymaster® EP 50:1 480-Volt AC Hazardous Location – Skid

Item #	Part #	Description
Fig. 4		
—	20100983	Spraymaster® EP 50:1 480-Volt AC Hazardous Location – Skid
1	20G255771	Control Box
2	—	Air Motor and Lower Pump Assembly <i>(See Fig. 13)</i>
3	20101082	Spraymaster® 25 Gallon Heated Coatings Tank – Complete <i>(Two Required)</i>
4	—	Air-In Manifold Assembly <i>(See Fig. 18)</i>
5	10ME1	3/4" NPT (M) Coupling – 2-lug
6	20100195	3/8-16 x 1" Zinc Bolt <i>(Eight Required)</i>
7	20100138	3/8-16 Hex Lock Nut Zinc <i>(12 Required)</i>
8	10102331	3/8" SAE Flat Washer Zinc <i>(12 Required)</i>
9	20100284	Flush Pump Mounting Bracket
10	20100287	7.5 Kva Transformer
11	20G255684	Mix Manifold
12	20G245864	In-line Paint Heater <i>(Two Required)</i>
13	20G262393	Flush Pump
14	20100279	30 AMP Receptacle
15	20G255478	Dose Valve <i>(Two Required)</i>
16	—	Air Manifold Assembly <i>(See Fig. 14)</i>
17	20MXPXCE161606N4	Hazardous Duty Distribution Panel <i>(See Fig. 17)</i>
18	20100921	Round Tank Frame
19	20100103	Dosing Manifold Bracket
—	20TAH100312	Static Mixer 3/8" Diameter x 12 <i>(Two Required) (Not Shown)</i>
—	20BEAKER1000ML	1000 Milliliter Test Beaker
—	2091000	Hazard Decals
—	20100564	Liquid Level Control Sensor Kit – Optional

PART NUMBERS AND SCHEMATICS GUIDE

Figure 4: Spraymaster® EP 50:1 480-Volt AC Hazardous Location – Skid

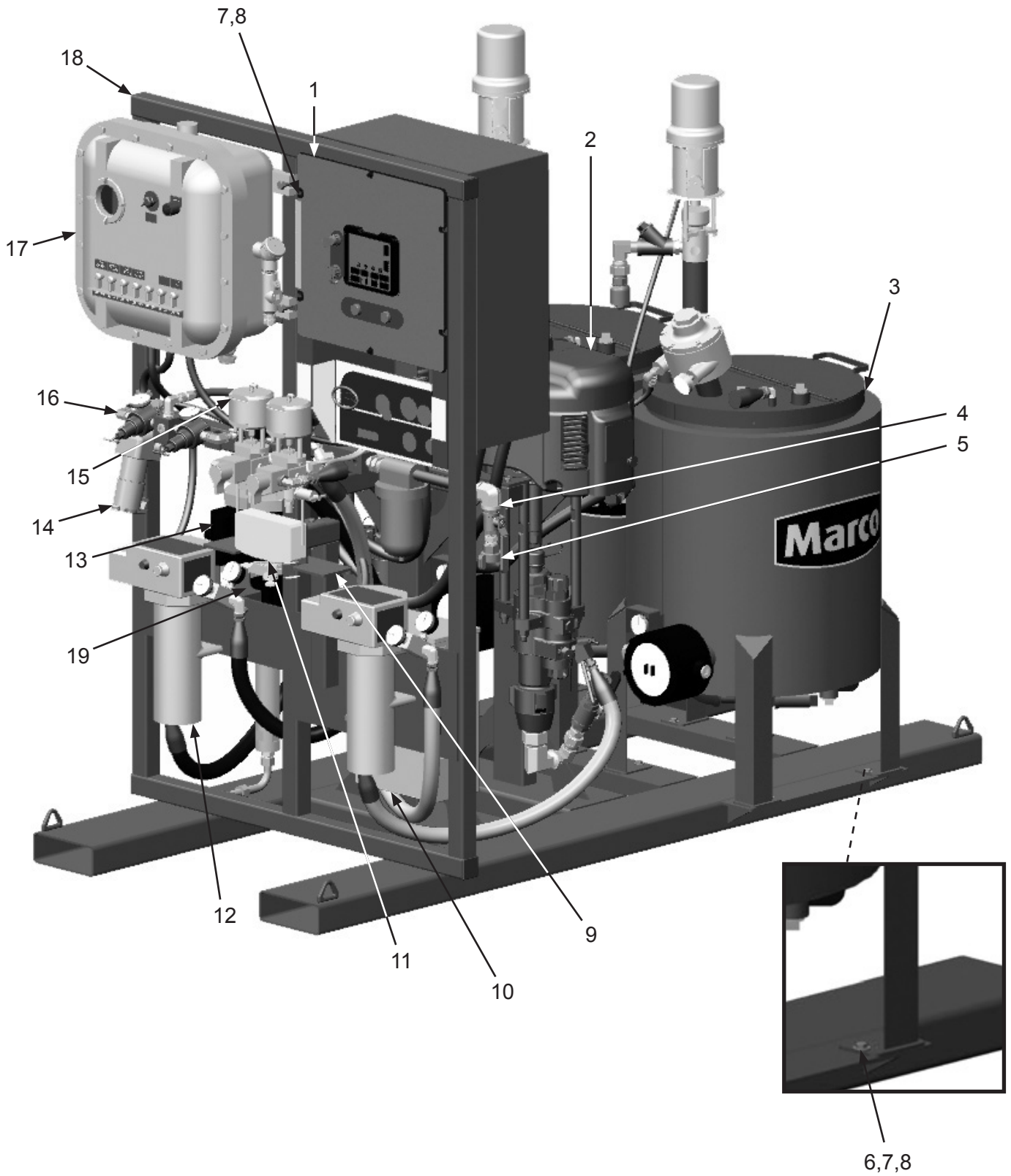

PART NUMBERS AND SCHEMATICS GUIDE

Spraymaster® EP 50:1 240-Volt AC General Purpose – Short Skid

Item #	Part #	Description
Fig. 5		
—	20101144	Spraymaster® EP 50:1 240-Volt AC General Purpose – Short Skid
1	20G255771	Control Box
2	—	Air Motor and Lower Pump Assembly <i>(See Fig. 13)</i>
3	—	Air-In Manifold Assembly <i>(See Fig. 18)</i>
4	10ME1	3/4" NPT (M) Coupling – 2-lug
5	20100103	Dosing Manifold Bracket
6	20G255684	Mix Manifold
7	20G245869	In-line Paint Heater <i>(Two Required)</i>
8	20G262393	Flush Pump
9	20G255478	Dose Valve <i>(Two Required)</i>
10	20100072	Electrical Box <i>(See Fig. 16)</i>
11	20100488	Round Tank Frame – Short Skid
12	20100284	Flush Pump Mounting Bracket
13	20100125	1/4-20 x 3/4" Zinc Bolt <i>(Four Required)</i>
14	1012153	1/4" Lock Washer <i>(Four Required)</i>
15	20100138	3/8-16 Hex Lock Nut Zinc <i>(Four Required)</i>
16	10102331	3/8" SAE Flat Washer Zinc <i>(Four Required)</i>
—	20TAH100312	Static Mixer 3/8" Diameter x 12 <i>(Two Required) (Not Shown)</i>
—	20BEAKER1000ML	1000 Milliliter Test Beaker
—	2091000	Hazard Decals
—	20100564	Liquid Level Control Sensor Kit – Optional

PART NUMBERS AND SCHEMATICS GUIDE

Figure 5: Spraymaster® EP 50:1 240-Volt AC General Purpose – Short Skid

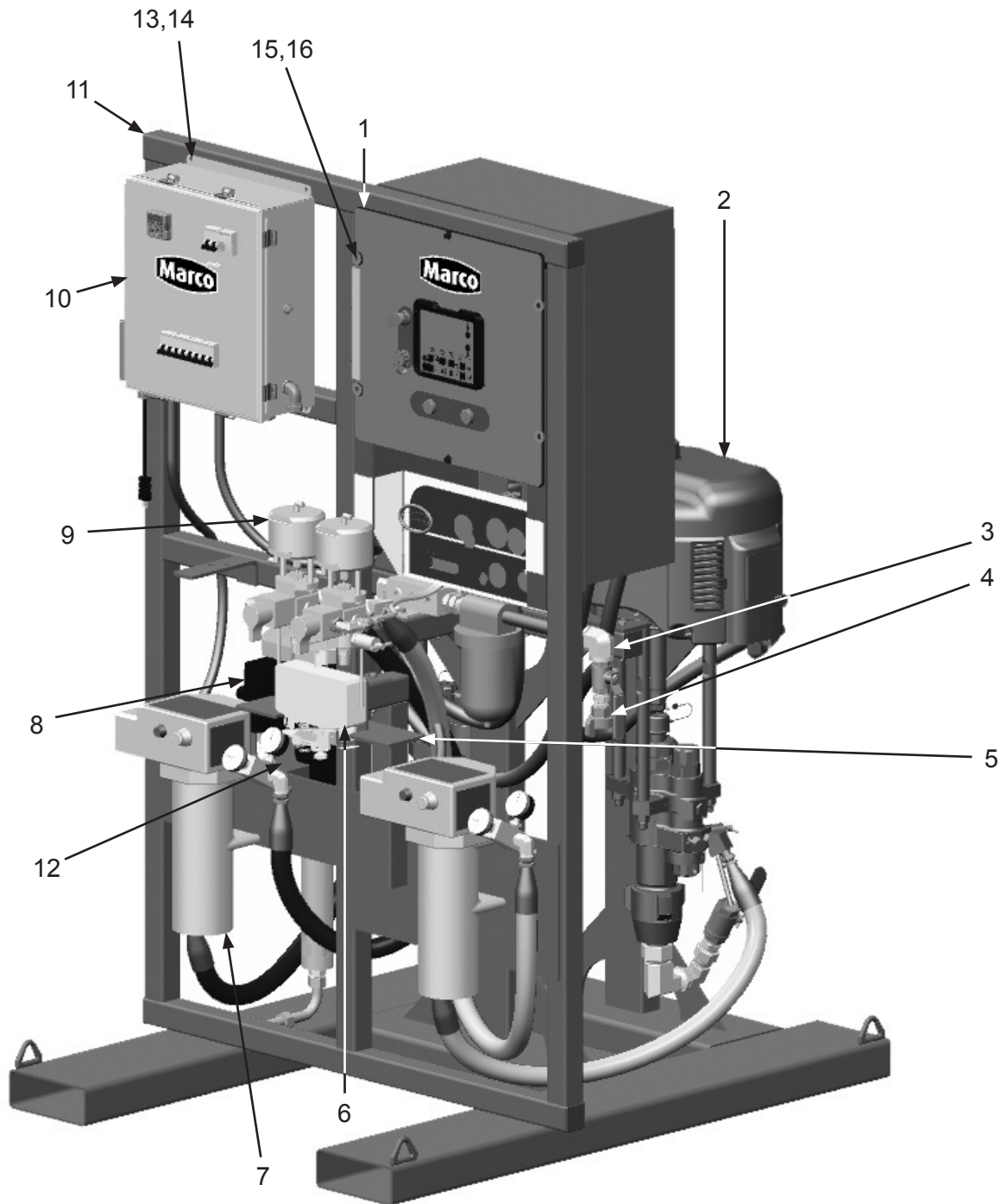

PART NUMBERS AND SCHEMATICS GUIDE

Spraymaster® EP 50:1 240-Volt AC Hazardous Location – Short Skid

Item #	Part #	Description
Fig. 6		
—	20101145	Spraymaster® EP 50:1 240-Volt AC Hazardous Location – Short Skid
1	20G255771	Control Box
2	—	Air Motor and Lower Pump Assembly <i>(See Fig. 13)</i>
3	—	Air-In Manifold Assembly <i>(See Fig. 18)</i>
4	10ME1	3/4" NPT (M) Coupling – 2-lug
5	20100284	Flush Pump Mounting Bracket
6	20G255684	Mix Manifold
7	20G245869	In-line Paint Heater <i>(Two Required)</i>
8	20G262393	Flush Pump
9	20100279	30 AMP Receptacle
10	20G255478	Dose Valve <i>(Two Required)</i>
11	20MXPXCE161606N4	Hazardous Duty Distribution Panel <i>(See Fig. 17)</i>
12	20100488	Round Tank Frame – Short Skid
13	20100103	Dosing Manifold Bracket
14	20100138	3/8-16 Hex Lock Nut Zinc <i>(Four Required)</i>
15	10102331	3/8" SAE Flat Washer Zinc <i>(Four Required)</i>
—	20TAH100312	Static Mixer 3/8" Diameter x 12 <i>(Two Required) (Not Shown)</i>
—	20BEAKER1000ML	1000 Milliliter Test Beaker
—	2091000	Hazard Decals
—	20100564	Liquid Level Control Sensor Kit – Optional

PART NUMBERS AND SCHEMATICS GUIDE

Figure 6: Spraymaster® EP 50:1 240-Volt AC Hazardous Location – Short Skid

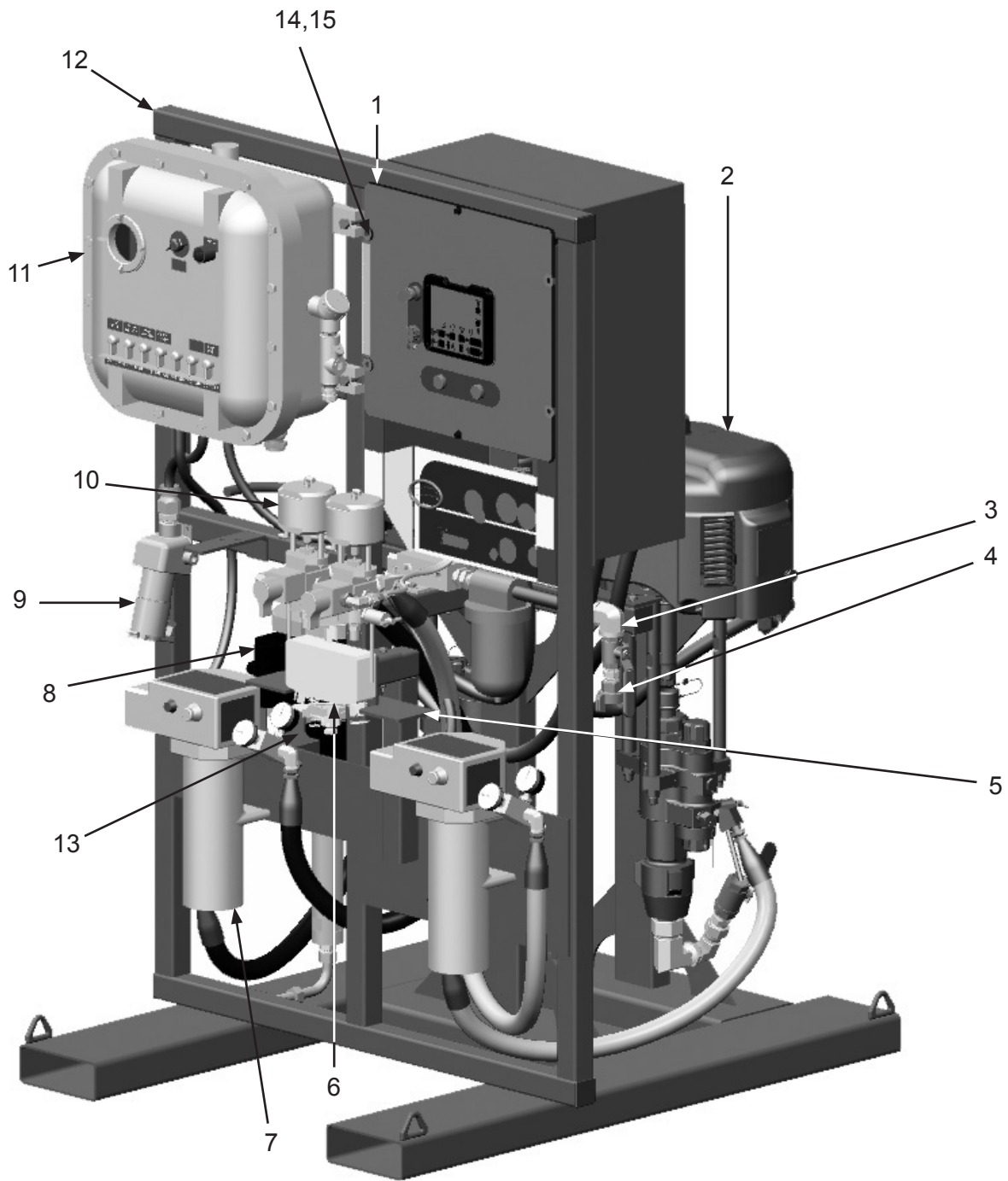

PART NUMBERS AND SCHEMATICS GUIDE

Spraymaster® EP 50:1 480-Volt AC General Purpose – Short Skid

Item #	Part #	Description
Fig. 7		
—	20100676	Spraymaster® EP 50:1 480-Volt AC General Purpose – Short Skid
1	20G255771	Control Box
2	—	Air Motor and Lower Pump Assembly <i>(See Fig. 13)</i>
3	—	Air-In Manifold Assembly <i>(See Fig. 18)</i>
4	10ME1	3/4" NPT (M) Coupling – 2-lug
5	20G106150	Air Line Filter
6	20100287	7.5 Kva Transformer
7	20G255684	Mix Manifold
8	20G245864	In-line Paint Heater <i>(Two Required)</i>
9	20G262393	Flush Pump
10	20G255478	Dose Valve <i>(Two Required)</i>
11	20000051	Electrical Box <i>(See Fig. 16)</i>
12	20100488	Round Tank Frame – Short Skid
13	20100103	Dosing Manifold Bracket
14	20100125	1/4-20 x 3/4" Zinc Bolt <i>(Four Required)</i>
15	1012153	1/4" Lock Washer <i>(Four Required)</i>
16	20100138	3/8-16 Hex Lock Nut Zinc <i>(Four Required)</i>
17	10102331	3/8" SAE Flat Washer Zinc <i>(Four Required)</i>
—	20TAH100312	Static Mixer 3/8" Diameter x 12 <i>(Two Required) (Not Shown)</i>
—	20BEAKER1000ML	1000 Milliliter Test Beaker
—	2091000	Hazard Decals
—	20100564	Liquid Level Control Sensor Kit – Optional

PART NUMBERS AND SCHEMATICS GUIDE

Figure 7: Spraymaster® EP 50:1 480-Volt AC General Purpose – Short Skid

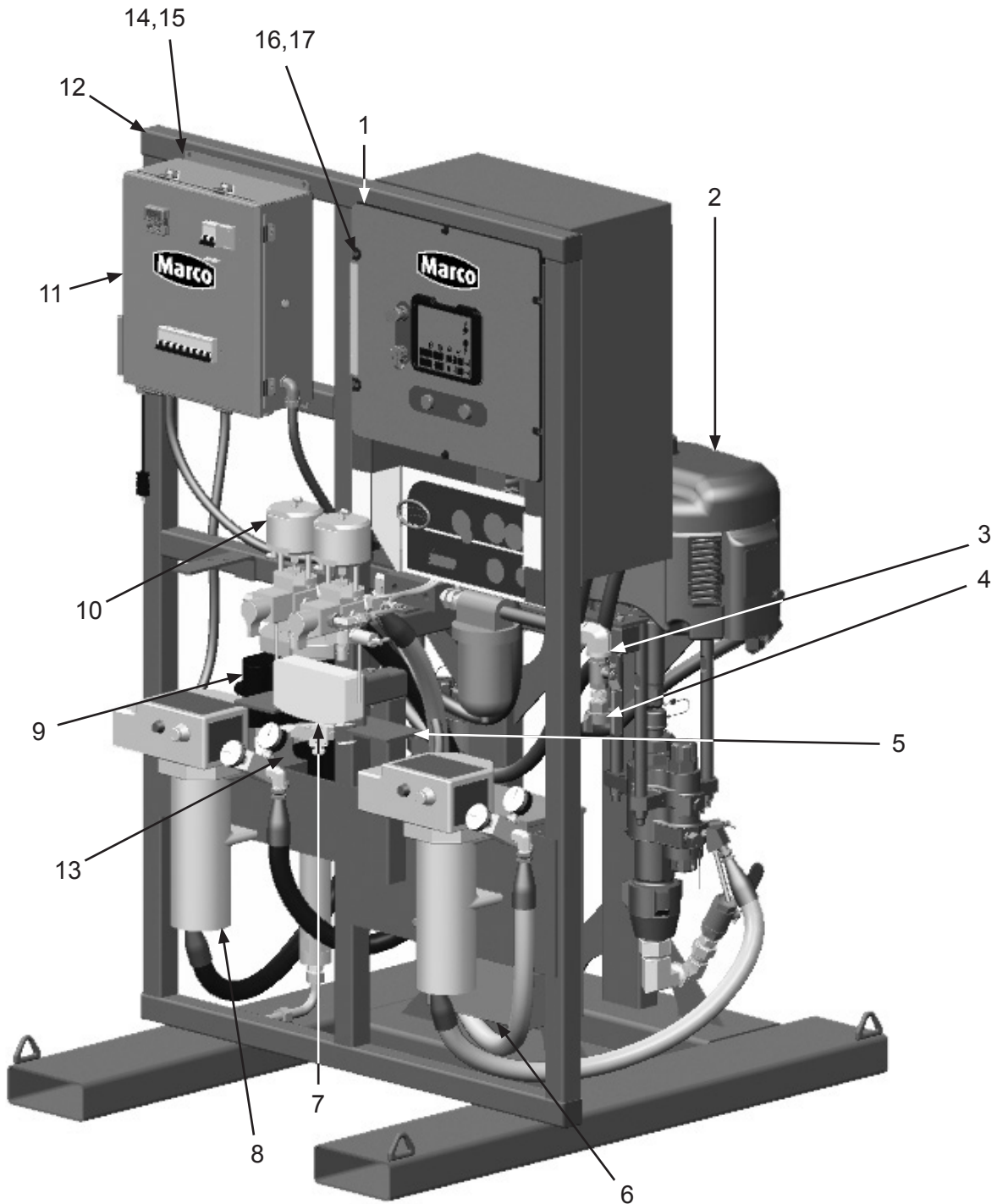

PART NUMBERS AND SCHEMATICS GUIDE

Spraymaster® EP 50:1 480-Volt AC Hazardous Location – Short Skid

Item #	Part #	Description
Fig. 8		
—	20100528	Spraymaster® EP 50:1 480-Volt AC Hazardous Location – Short Skid
1	20G255771	Control Box
2	—	Air Motor and Lower Pump Assembly <i>(See Fig. 13)</i>
3	—	Air-In Manifold Assembly <i>(See Fig. 18)</i>
4	10ME1	3/4" NPT (M) Coupling – 2-lug
5	20100284	Flush Pump Mounting Bracket
6	20100287	7.5 Kva Transformer
7	20G255684	Mix Manifold
8	20G245864	In-line Paint Heater <i>(Two Required)</i>
9	20G262393	Flush Pump
10	20100279	30 AMP Receptacle
11	20G255478	Dose Valve <i>(Two Required)</i>
12	20MXPXCE161606N4	Hazardous Duty Distribution Panel <i>(See Fig. 17)</i>
13	20100488	Round Tank Frame – Short Skid
14	20100103	Dosing Manifold Bracket
15	20100138	3/8-16 Hex Lock Nut Zinc <i>(Four Required)</i>
16	10102331	3/8" SAE Flat Washer Zinc <i>(Four Required)</i>
—	20TAH100312	Static Mixer 3/8" Diameter x 12 <i>(Two Required) (Not Shown)</i>
—	20BEAKER1000ML	1000 Milliliter Test Beaker
—	2091000	Hazard Decals
—	20100564	Liquid Level Control Sensor Kit – Optional

PART NUMBERS AND SCHEMATICS GUIDE

Figure 8: Spraymaster® EP 50:1 480-Volt AC Hazardous Location – Short Skid

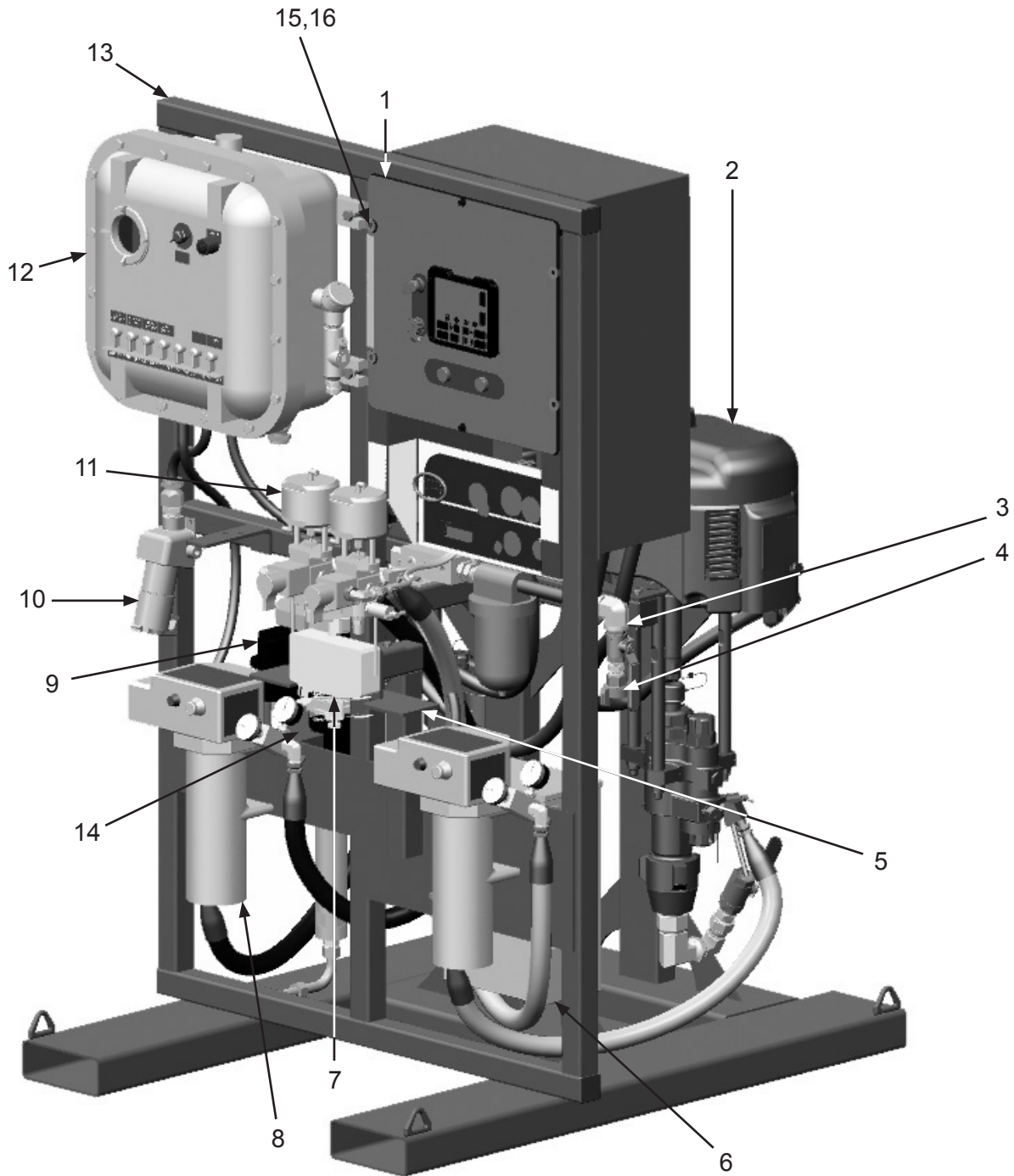

PART NUMBERS AND SCHEMATICS GUIDE

Spraymaster® EP 50:1 240-Volt AC General Purpose – Cart

Item #	Part #	Description
Fig. 9		
—	20101137	Spraymaster® EP 50:1 240-Volt AC General Purpose – Cart
1	20G255771	Control Box
2	—	Air Motor and Lower Pump Assembly (<i>See Fig. 13</i>)
3	20101081	Spraymaster® 25 Gallon Heated Coatings Tank – Complete (<i>Two Required</i>)
4	—	Air-In Manifold Assembly (<i>See Fig. 18</i>)
5	10ME1	3/4" NPT (M) Coupling – 2-lug
6	20100692	Rear Wheel Assembly (<i>Two Required</i>)
7	20100138	3/8-16 Hex Lock Nut Zinc (<i>12 Required</i>)
8	10102331	3/8" SAE Flat Washer Zinc (<i>12 Required</i>)
9	20100195	3/8-16 x 1" Zinc Bolt (<i>Eight Required</i>)
10	20100284	Flush Pump Mounting Bracket
11	20G255684	Mix Manifold
12	20G245869	In-line Paint Heater (<i>Two Required</i>)
13	20100698	Front Wheel Assembly
14	20G262393	Flash Pump
15	20G255478	Dose Valve (<i>Two Required</i>)
16	—	Air Manifold Assembly (<i>See Fig. 14</i>)
17	20100072	Electrical Box (<i>See Fig. 16</i>)
18	20100921	Round Tank Frame – Skid
19	20100103	Dosing Manifold Bracket
20	20100125	1/4-20 x 3/4" Zinc Bolt (<i>Four Required</i>)
21	1012153	1/4" Lock Washer (<i>Four Required</i>)
—	20TAH100312	Static Mixer 3/8" Diameter x 12 (<i>Two Required</i>) (<i>Not Shown</i>)
—	20BEAKER1000ML	1000 Milliliter Test Beaker
—	2091000	Hazard Decals
—	20100564	Liquid Level Control Sensor Kit – Optional

PART NUMBERS AND SCHEMATICS GUIDE

Figure 9: Spraymaster® EP 50:1 240-Volt AC General Purpose – Cart

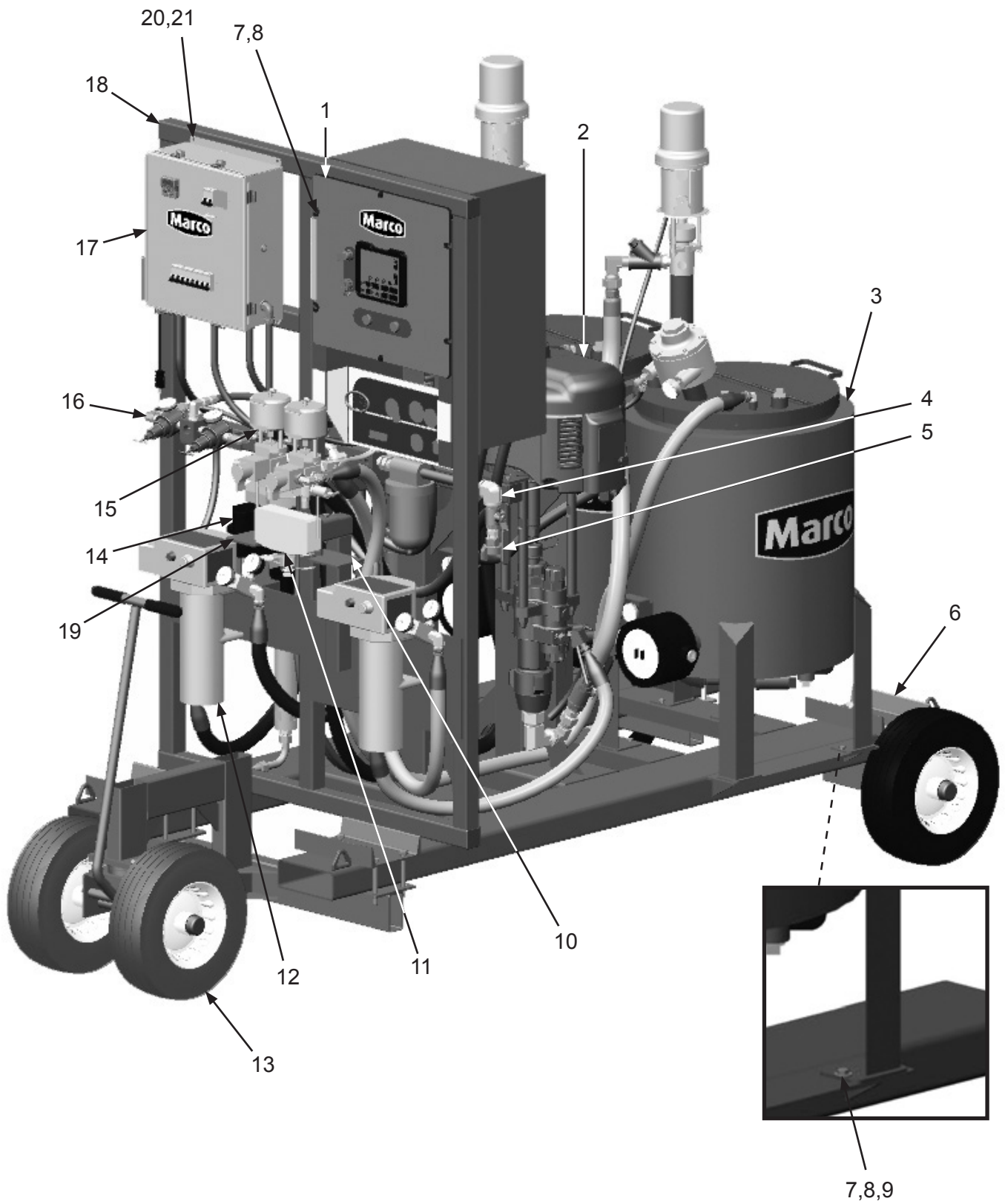

PART NUMBERS AND SCHEMATICS GUIDE

Spraymaster® EP 50:1 240-Volt AC Hazardous Location – Cart

Item #	Part #	Description
Fig. 10		
—	20101139	Spraymaster® EP 50:1 240-Volt AC Hazardous Location – Cart
1	20G255771	Control Box
2	—	Air Motor and Lower Pump Assembly <i>(See Fig. 13)</i>
3	20101081	Spraymaster® 25 Gallon Heated Coatings Tank – Complete <i>(Two Required)</i>
4	—	Air-In Manifold Assembly <i>(See Fig. 18)</i>
5	10ME1	3/4" NPT (M) Coupling – 2-lug
6	20100692	Rear Wheel Assembly <i>(Two Required)</i>
7	20100138	3/8-16 Hex Lock Nut Zinc <i>(12 Required)</i>
8	10102331	3/8" SAE Flat Washer Zinc <i>(12 Required)</i>
9	20100195	3/8-16 x 1" Zinc Bolt <i>(Eight Required)</i>
10	20100284	Flush Pump Mounting Bracket
11	20G255684	Mix Manifold
12	20G245869	In-line Paint Heater <i>(Two Required)</i>
13	20100698	Front Wheel Assembly
14	20G262393	Flash Pump
15	20100279	30 AMP Receptacle
16	20G255478	Dose Valve <i>(Two Required)</i>
17	—	Air Manifold Assembly <i>(See Fig. 14)</i>
18	20MXPXCE161606N4	Hazardous Duty Distribution Panel <i>(See Fig. 17)</i>
19	20100921	Round Tank Frame – Skid
20	20100103	Dosing Manifold Bracket
—	20TAH100312	Static Mixer 3/8" Diameter x 12 <i>(Two Required) (Not Shown)</i>
—	20BEAKER1000ML	1000 Milliliter Test Beaker
—	2091000	Hazard Decals
—	20100564	Liquid Level Control Sensor Kit – Optional

PART NUMBERS AND SCHEMATICS GUIDE

Figure 10: Spraymaster® EP 50:1 240-Volt AC Hazardous Location – Cart

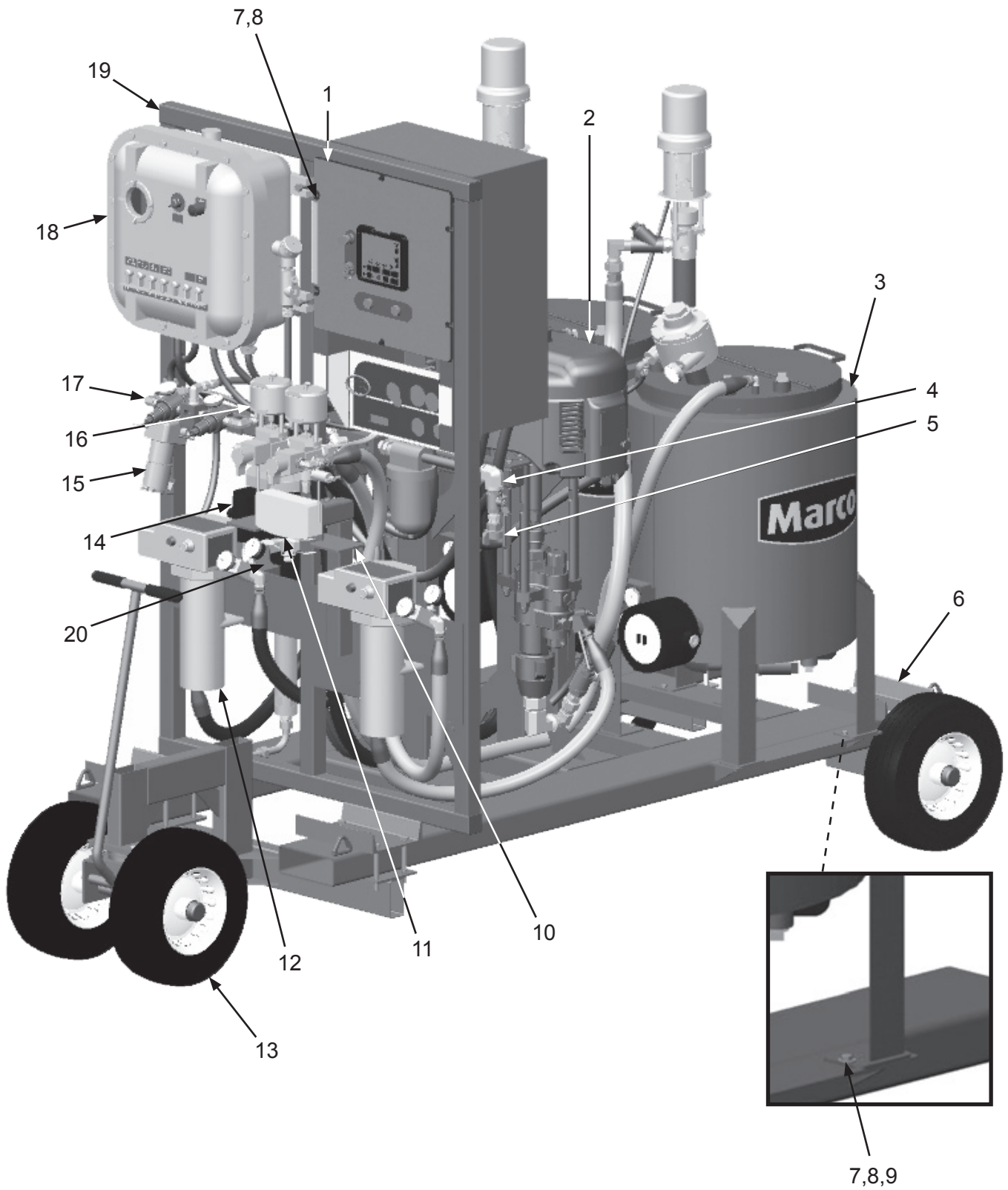

PART NUMBERS AND SCHEMATICS GUIDE

Spraymaster® EP 50:1 480-Volt AC General Purpose – Cart

Item #	Part #	Description
Fig. 11		
—	20101138	Spraymaster® EP 50:1 480-Volt AC General Purpose – Cart
1	20G255771	Control Box
2	—	Air Motor and Lower Pump Assembly <i>(See Fig. 13)</i>
3	20101082	Spraymaster® 25 Gallon Heated Coatings Tank – Complete <i>(Two Required)</i>
4	—	Air-In Manifold Assembly <i>(See Fig. 18)</i>
5	10ME1	3/4" NPT (M) Coupling – 2-lug
6	20100692	Rear Wheel Assembly <i>(Two Required)</i>
7	20100138	3/8-16 Hex Lock Nut Zinc <i>(12 Required)</i>
8	10102331	3/8" SAE Flat Washer Zinc <i>(12 Required)</i>
9	20100195	3/8-16 x 1" Zinc Bolt <i>(Eight Required)</i>
10	20100284	Flush Pump Mounting Bracket
11	20100287	7.5 Kva Transformer
12	20G255684	Mix Manifold
13	20G245864	In-line Paint Heater <i>(Two Required)</i>
14	20100698	Front Wheel Assembly
15	20G262393	Flush Pump
16	20G255478	Dose Valve <i>(Two Required)</i>
17	—	Air Manifold Assembly <i>(See Fig. 14)</i>
18	20000051	Electrical Box <i>(See Fig. 16)</i>
19	20100921	Round Tank Frame – Skid
20	20100103	Dosing Manifold Bracket
21	20100125	1/4-20 x 3/4" Zinc Bolt <i>(Four Required)</i>
22	1012153	1/4" Lock Washer <i>(Four Required)</i>
—	20TAH100312	Static Mixer 3/8" Diameter x 12 <i>(Two Required) (Not Shown)</i>
—	20BEAKER1000ML	1000 Milliliter Test Beaker
—	2091000	Hazard Decals
—	20100564	Liquid Level Control Sensor Kit – Optional

PART NUMBERS AND SCHEMATICS GUIDE

Figure 11: Spraymaster® EP 50:1 480-Volt AC General Purpose – Cart

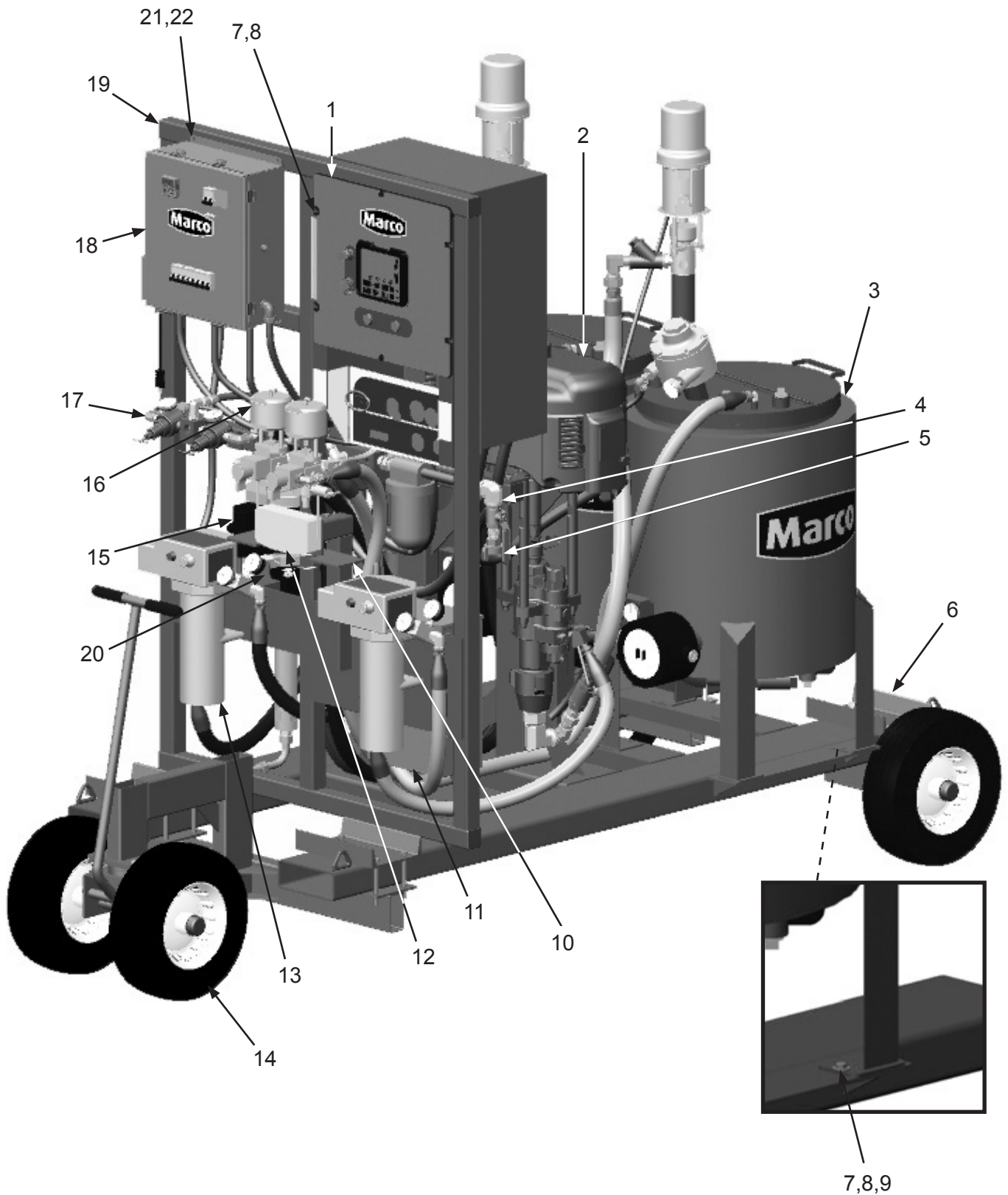

PART NUMBERS AND SCHEMATICS GUIDE

Spraymaster® EP 50:1 480-Volt AC Hazardous Location – Cart

Item #	Part #	Description
Fig. 12		
—	20101140	Spraymaster® EP 50:1 480-Volt AC Hazardous Location – Cart
1	20G255771	Control Box
2	—	Air Motor and Lower Pump Assembly <i>(See Fig. 13)</i>
3	20101082	Spraymaster® 25 Gallon Heated Coatings Tank – Complete <i>(Two Required)</i>
4	—	Air-In Manifold Assembly <i>(See Fig. 18)</i>
5	10ME1	3/4" NPT (M) Coupling – 2-lug
6	20100692	Rear Wheel Assembly <i>(Two Required)</i>
7	20100138	3/8-16 Hex Lock Nut Zinc <i>(12 Required)</i>
8	10102331	3/8" SAE Flat Washer Zinc <i>(12 Required)</i>
9	20100195	3/8-16 x 1" Zinc Bolt <i>(Eight Required)</i>
10	20100284	Flush Pump Mounting Bracket
11	20100287	7.5 Kva Transformer
12	20G255684	Mix Manifold
13	20G245864	In-line Paint Heater <i>(Two Required)</i>
14	20100698	Front Wheel Assembly
15	20G262393	Flash Pump
16	20100279	30 AMP Receptacle
17	20G255478	Dose Valve <i>(Two Required)</i>
18	—	Air Manifold Assembly <i>(See Fig. 14)</i>
19	20MXPXCE161606N4	Hazardous Duty Distribution Panel <i>(See Fig. 17)</i>
20	20100921	Round Tank Frame – Skid
21	20100103	Dosing Manifold Bracket
—	20TAH100312	Static Mixer 3/8" Diameter x 12 <i>(Two Required) (Not Shown)</i>
—	20BEAKER1000ML	1000 Milliliter Test Beaker
—	2091000	Hazard Decals
—	20100564	Liquid Level Control Sensor Kit – Optional

PART NUMBERS AND SCHEMATICS GUIDE

Figure 12: Spraymaster® EP 50:1 480-Volt AC Hazardous Location – Cart

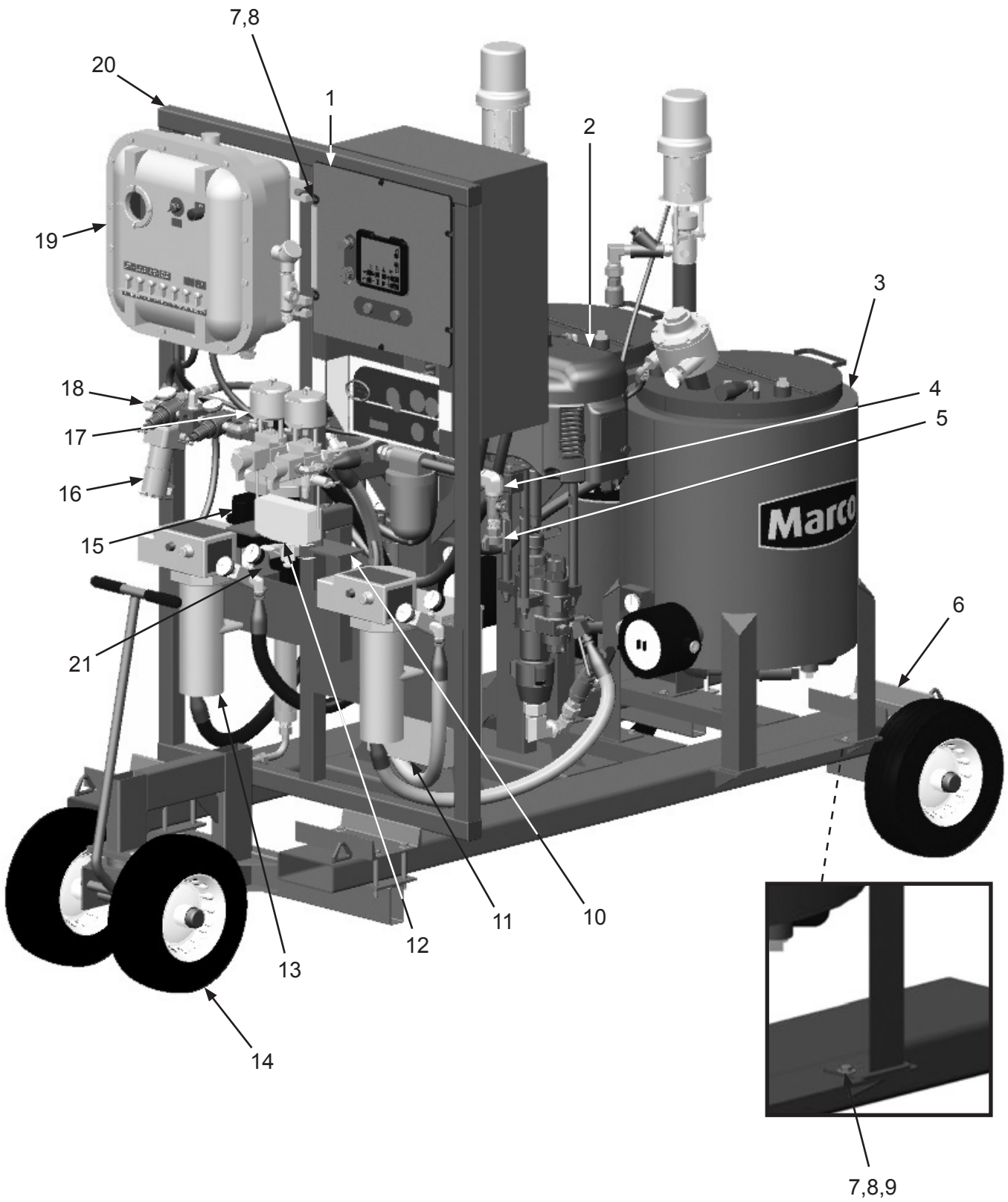

PART NUMBERS AND SCHEMATICS GUIDE

Spraymaster® EP-50 Air Motor & Lower Pump Assembly

Item #	Part #	Description
Fig. 13		
1	20G257055	Air Motor
2	20100063	Pump Mounting Plate
3	1014231	3/8-16 x 2-3/4" Grade 5 Hex
4	1014241	3/8" I.D. x 3/4" O.D. Washer
5	20100138	3/8-16 Zinc Hex Lock Nut
6	20100217	1" Fluid Hose – 4' Green
7	10AH012	Air Hose 1/2" I.D. 300 psi
8	1011601	1" Full Port Ball Valve
9	20PFHA24SA1616	1" Hex Nipple
10	20PFHA60UA1616	1" (M) x 1" (F) 90° Swivel
11	20PFHA24SB2016	1-1/4" x 1" Reducing Bushing
12	20PFHA60UG2020	1-1/4" (F) x 1-1/4" (F) 90°
13	20100207	1/2" Insulated Hose – Green 3'

PART NUMBERS AND SCHEMATICS GUIDE

Figure 13: Spraymaster® EP-50 Air Motor & Lower Pump Assembly

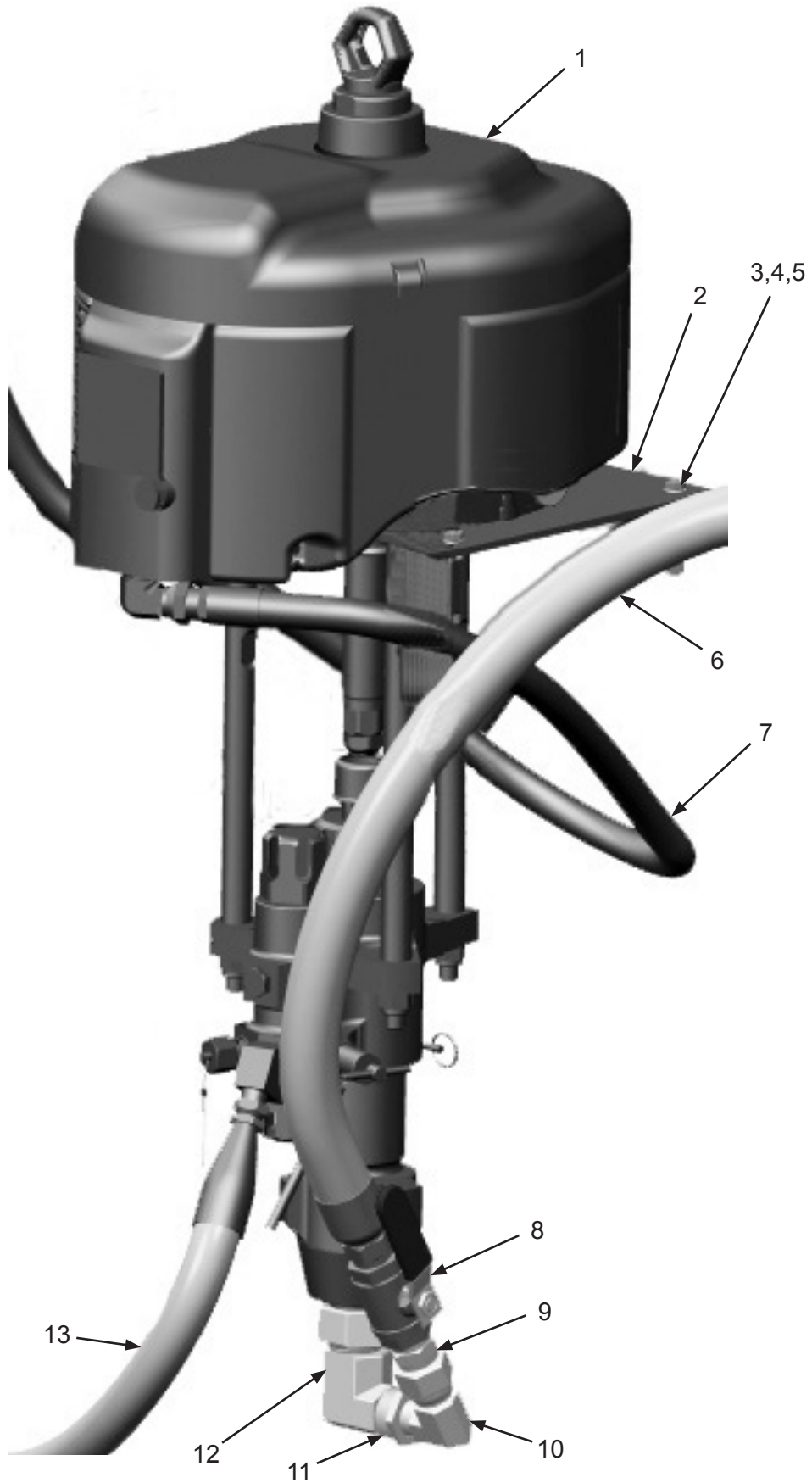

PART NUMBERS AND SCHEMATICS GUIDE

Air Manifold Assembly

Item #	Part #	Description
Fig. 14		
1	10AH038	3/8" I.D. Air Hose <i>(Two Required)</i>
2	10AH012	Air Hose 1/2" I.D. 300 psi
3	1080060	3/8" Full Port Ball Valve <i>(Two Required)</i>
4	20PFHA25UJ06	3/8" NPT (F) 90° Elbow <i>(Two Required)</i>
5	208020	3/8" Air Fluid Hose Fitting <i>(Two Required)</i>
6	20PFHA24SA0606	3/8" Hex Nipple 7200 Psi <i>(Two Required)</i>
7	1011209	3/8" Close Nipple <i>(Two Required)</i>
8	20PFHA24SA0806	3/8" x 1/2" Hex Nipple <i>(Four Required)</i>
9	20G101689B	0-200 psi Gauge <i>(Two Required)</i>
10	20G104266	1/2" Air Regulator <i>(Two Required)</i>
11	20PFHA25UA0808	1/2" NPT (M) 90° Elbow
12	20PFHFHU0808ND	Crimp on Hose End 1/2" Female Pipe
13	20100094	Air Manifold
14	20RPLG75R	3/4" Recessed Plug
15	20PFHA24SB1208	3/4" to 1/2" NPT Bushing
16	20100195	3/8-16 x 1" Zinc Bolt
17	10100674	1/2" Flat Washer
18	20100138	3/8-16 Hex Lock Nut Zinc

PART NUMBERS AND SCHEMATICS GUIDE

Figure 14: Air Manifold Assembly

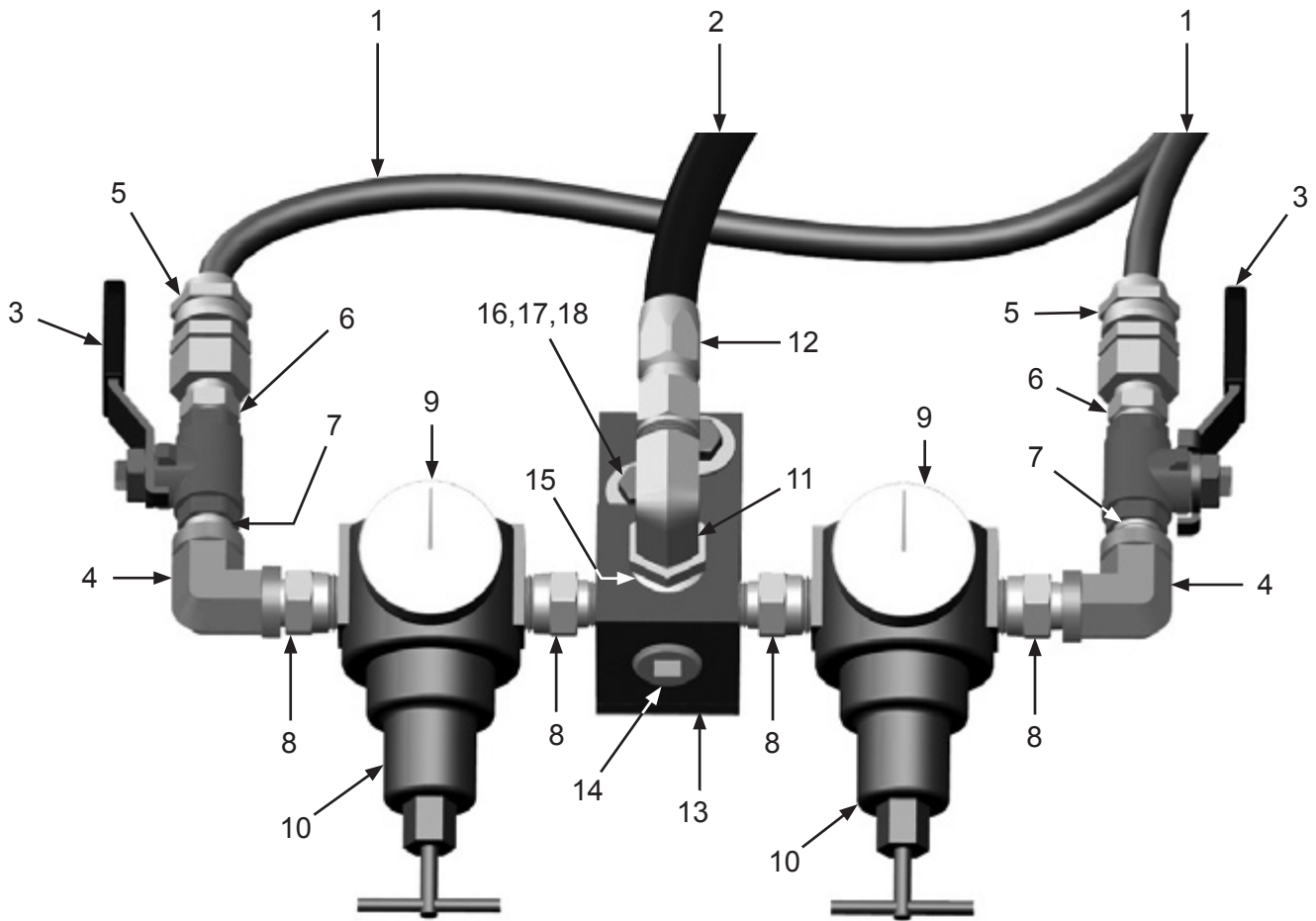

PART NUMBERS AND SCHEMATICS GUIDE

Wheel Kit

Item #	Part #	Description
Fig. 15		
1	20100160	1/2-13 x 4-1/2" Hex Bolt <i>(16 Required)</i>
2	10100674	1/2" Flat Washer <i>(34 Required)</i>
3	20100118	Cart Handle
4	20100696	Clamping Channel <i>(Four Required)</i>
5	20100698	Front Wheel Assembly <i>(Includes Item #'s: 1 (Quantity of Eight), 2 (Quantity of 18), 3, 4, 5, 6 (Quantity of Eight), 7 (Quantity of 12), 8, 9, 10, 11 (Quantity of Eight), 12 (Quantity of Two), 13 (Quantity of Nine), 14, 15 (Quantity of Two), 16 (Quantity of Two), 17 (Quantity of Two) and 18 (Quantity of Two))</i>
6	10104234	3/8-16 x 1-1/4" Hex Bolt <i>(Eight Required)</i>
7	1014241	3/8" Flat Washer <i>(16 Required)</i>
8	20100107	Front Swivel
9	20100123	1/2-13 x 8-1/2" Hex Bolt
10	1014241	16" Pneumatic Wheel Assembly <i>(Four Required)</i>
11	20100138	3/8-16 Hex Locknut <i>(Eight Required)</i>
12	20100147	1-1/2" Cotter Pin 7/64" Diameter <i>(Four Required)</i>
13	20100124	1/2-13 Hex Locknut <i>(17 Required)</i>
14	20100114	Front Axle Weldment
15	20100148	1" I.D. x 1-1/2" O.D. 10-Gauge Washer <i>(Four Required)</i>
16	20100149	3/4-10 Slotted Hex Nut <i>(Four Required)</i>
17	20100693	Front Wheel Weldment
18	1011766	Moisture Separator Grip <i>(Two Required)</i>
19	20100692	Rear Wheel Assembly <i>(Two Required) (Includes Item #'s: 1 (Quantity of Four), 2 (Quantity of Eight), 4, 10, 12, 13 (Quantity of Four), 15, and 16)</i>

PART NUMBERS AND SCHEMATICS GUIDE

Figure 15: Wheel Kit

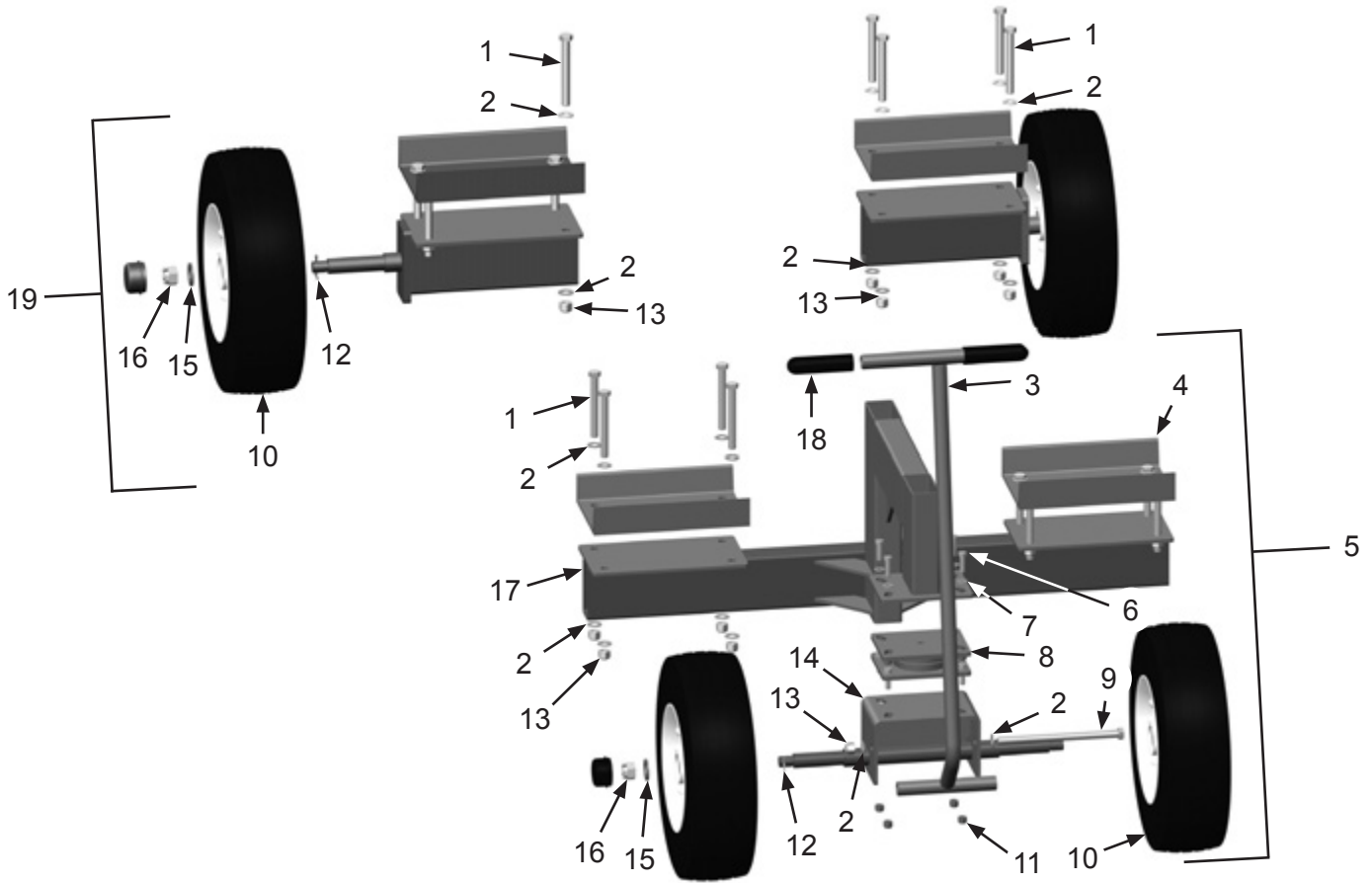

PART NUMBERS AND SCHEMATICS GUIDE

General Duty Control Box

Item #	Part #	Description
Fig. 16		
—	20100072	240-Volt Control Box, Four Circuit, Single Phase
1	20RMSJB161406CH44C	16" x 14" x 6" Enclosure, 4 Circuit
2	20MNPHTC	Nameplate – HOSE HEAT TEMP CTRL
3	20WTPM6C1CCARAAAAA	Hose Heat Control – 220-Volt
4	20RMG24456	50 Amp Circuit Breaker
5	20MNP HH	Nameplate – HOSE HEAT
6	20RMG26547	Double Pole GFI
7	1091042	Small Marco® Logo Sticker
8	20MNPRLH	Nameplate – RESIN LINE HEAT
9	20MNPCLH	Nameplate – CATALYST LINE HEAT
10	20MNP RTH	Nameplate – RESIN HEAT TANK
11	20MNPCTH	Nameplate – CATALYST TANK HEAT
12	20MNPTRANS	Nameplate – CONTROL TRANSFORMER
13	20RMG24453	25 Amp Circuit Breaker (<i>Four Required</i>)
14	20RST50	Straight Liquid Tite Connector (<i>Three Required</i>)
15	20CX308793	Female T/C Plug
16	20WTJ207502	Thermo Couple Wire, Non-Sheilded (<i>Per Foot</i>)
17	1019021	1/2" NPT Cord Grip, Aluminum .187–.312
18	20RHBL2620	L6-30 Twist-Lock Receptacle
19	20RLEV8402040	30 Amp Single Gang Cover, Stainless Steel
20	20RRX53200	Single Gang Electrical Box
21	20RST9050	90° Liquid Tite Connection Fitting
22	20RCG6275	3/4" Straight Cord Connector, Aluminum
23	20RP1614	16" x 14" Enclosure Back Panel
24	20R9080LBA362104	Power Distribution Block
25	20RUSM1	Fuse Holder with Indicator Light
26	20RW6250DSX1	50 Amp Solid State Relay

PART NUMBERS AND SCHEMATICS GUIDE

Figure 16: General Duty Control Box

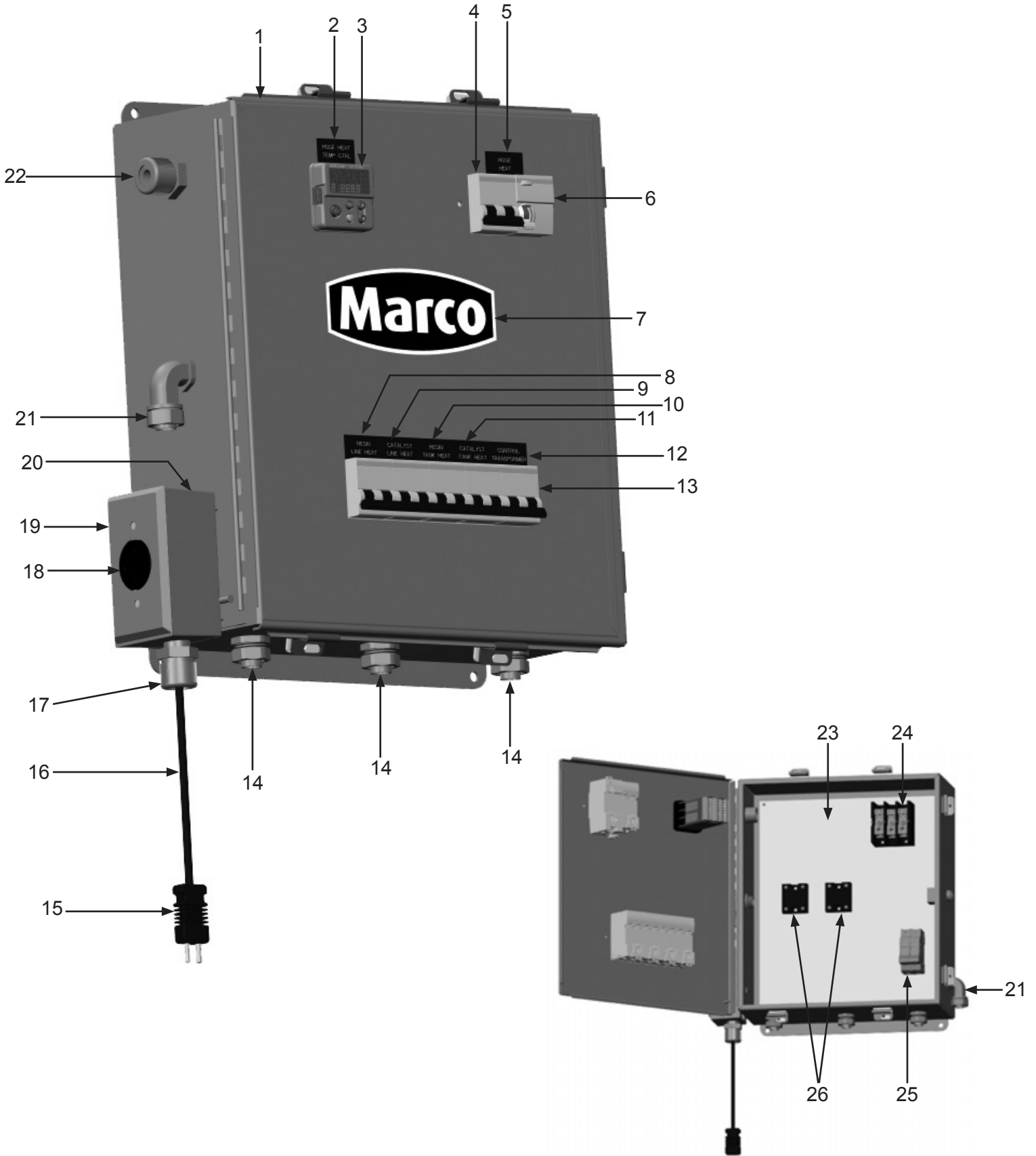

PART NUMBERS AND SCHEMATICS GUIDE

Hazardous Location Control Box

Item #	Part #	Description
Fig. 17		
—	20MXPXCE161606N4	Hazardous Duty Distribution Panel
1	20MNPRLH	Nameplate – Resin Line Heat
2	20MNPCLH	Nameplate – Catalyst Line Heat
3	20MNPPTH	Nameplate – Resin Heat Tank
4	20MNPCTH	Nameplate – Catalyst Tank Heat
5	20101152	Nameplate – Level Control Panel
6	20MNPTRANS	Nameplate – Control Transformer
7	20MNP HH	Nameplate – Hose Heat
8	1019021	Cord Grip 1/2"-NPT .187-.31
9	20PFHA24SA1612	3/4" x 1" Hex Nipple
10	20RST50	Straight Liquid Tite Connector
11	20REYM50	1/2" Mall Conduit Seal
12	10L803035	1/2" Close Nipple, Galvanized
13	20RELMFL9050	1/2" 90 Degree Electrical Fitting
14	1011213	3/4" Close Nipple, Galvanized
15	20100848	3/4" 90 Degree Pulling Elbow
16	20100660	3/4" Mall Conduit Seal
17	20RRB7550	3/4" to 1/2" Reducing Bushing

PART NUMBERS AND SCHEMATICS GUIDE

Figure 17: Hazardous Location Control Box

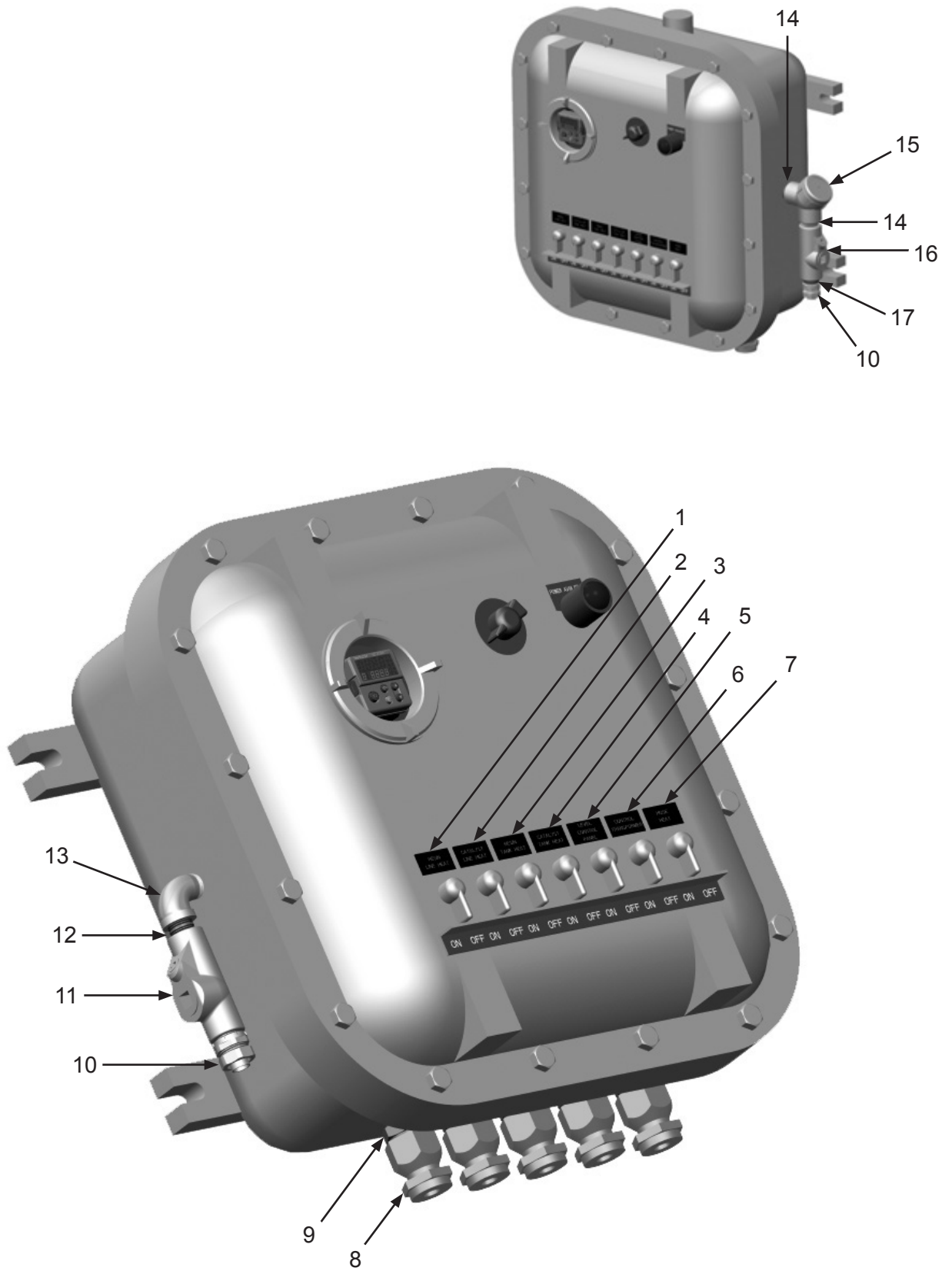

PART NUMBERS AND SCHEMATICS GUIDE

Figure 18: Air-In Manifold Assembly

Item #	Part #	Description
Fig. 18		
1	108074C	3/4" NPT Full Port Ball Valve
2	20100162	3/4" Galvanized 90° Elbow
3	20100283	3/4" x 10" Galvanized Pipe
4	20G106150	Air Line Filter
5	20PFHA24SA1212	3/4" Hex Nipple (<i>Two Required</i>)
6	20PFHA60SA1212	3/4" (M) x 3/4" (F) Swivel Union
7	20100326	8 Port Air Manifold Block
8	20PFHA25UA0808	1/2" NPT (M) 90° Elbow
9	20PFHFHU0808ND	Crimp on Hose End 1/2" Female Pipe
10	20PFHA60UA1212	3/4" (M) x 3/4" (F) 90° Swivel
11	20PFHA24SA0604	1/4" x 3/8" Hex Nipple
12	2080010	5/16" Air Hose Coupling
13	2080020	3/8" Air Fluid Hose Fitting (<i>Two Required</i>)
14	20100195	3/8-16 x 1" Zinc Bolt
15	10100674	1/2" Flat Washer
16	20100138	3/8-16 Hex Lock Nut Zinc
17	20PFHA24SA0606	3/8" Hex Nipple 7200 psi (<i>Two Required</i>)
18	10ME1	3/4" NPT (M) Coupling – 2-lug

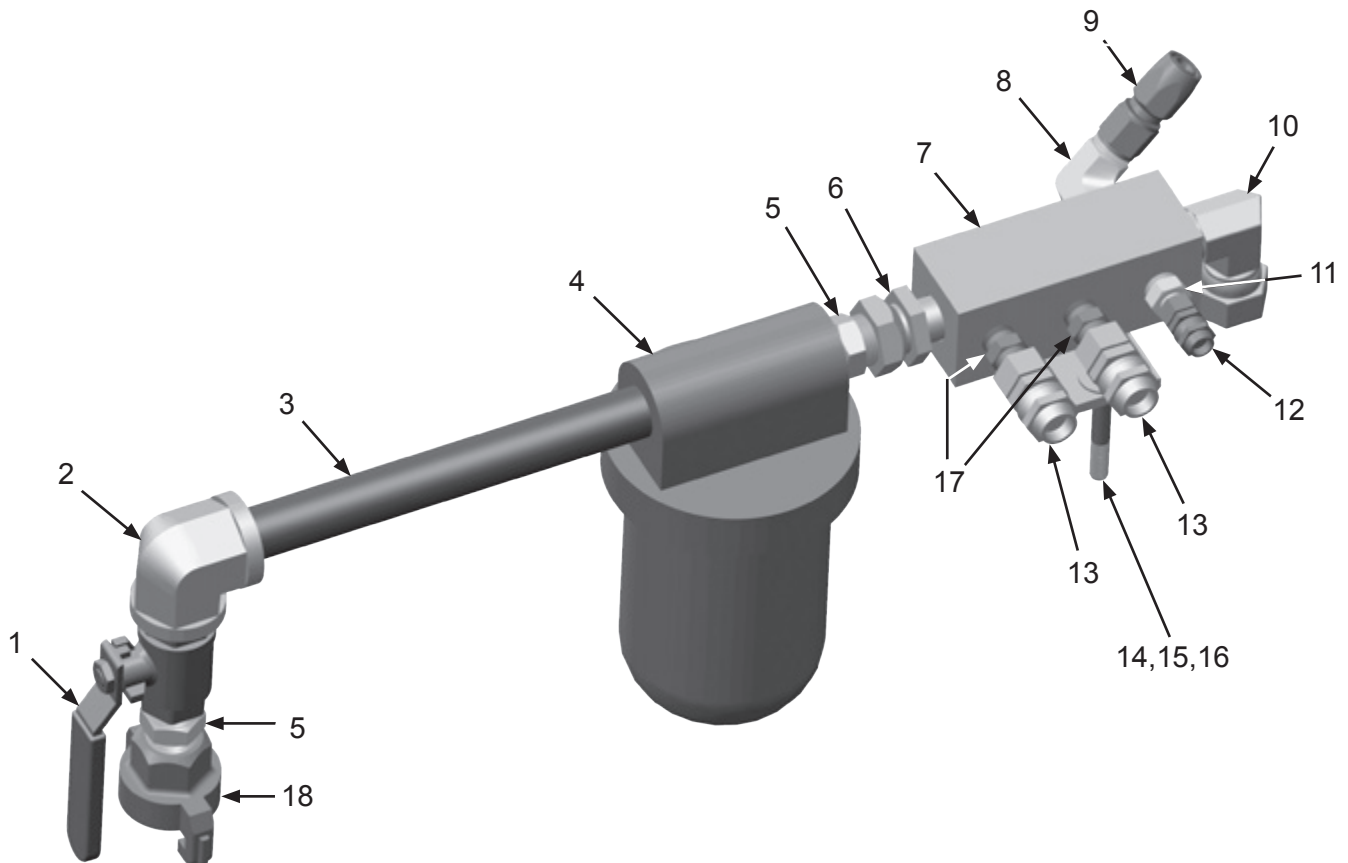

LITERATURE REFERENCES

Spraymaster® MP-35 Spray System

205M015	Features & Specifications Guide – Spraymaster® EP-50 Spray System
206M015	Part Numbers & Schematics Guide – Spraymaster® EP-50 Spray System
2090015	Operator's Manual – Spraymaster® EP-50 Spray System
2090114	Operator's Manual – Spraymaster® 25 Gallon Heated Coatings Tank
209V504	Operator's Manual – Merkur® Pump Assembly
209V505	Operator's Manual – Graco® Mix Manifold
209V506	Operator's Manual – Graco® Viscon High Pressure Fluid Heater
209V509	Operator's Manual – Graco® NXT® Air Motor
209V021	Operator's Manual – Graco® Xtreme® Lowers
209V510	Operator's Manual – Graco® Merkur® Displacement Pump
209V512	Operator's Manual – Graco® Low Volume Air Regulators
209V503	Operator's Manual – Graco® XPTM Proportioners

OPTIONAL ACCESSORIES

Part Numbers	5000 PSI ELECTRIC HEATED HOSE BUNDLES											
	General Purpose	Intrinsically Safe	Deadhead	Recirculating	Modified	Moisture-Lock	Airless Spray Hose I.D.	Solvent Hose I.D.	Length			
									50 Ft.	100 Ft.	150 Ft.	200 Ft.
20100431	X		X				1/4" x 3/8" x 1/2"	1/4"			X	
20100432	X		X				1/4" x 3/8" x 1/2"	1/4"				X
20100433	X			X			1/4" (Qty of Two) x 3/8" x 1/2"	1/4"			X	
20100434	X			X			3/8" (Qty of Three) x 1/2"	1/4"				X
20101025	X			X			1/4" (Qty of Three) x 1/2"	1/4"		X		
20100447	X					X	1/4" x 3/8"	1/4"			X	
20100448	X					X	1/4" x 3/8"	1/4"				X
20100436		X	X				1/4" x 3/8" x 1/2"	1/4"	X			
20100437		X	X				1/4" x 3/8" x 1/2"	1/4"		X		
20100438		X	X				1/4" x 3/8" x 1/2"	1/4"			X	
20100439		X	X				3/8" x 1/2"	1/4"				X
20100440		X		X			3/8" (Qty of Three) x 1/2"	1/4"	X			
20100441		X		X			1/4" (Qty of Two) x 3/8" x 1/2"	1/4"		X		
20100442		X		X			1/4" (Qty of Two) x 3/8" x 1/2"	1/4"			X	
20100443		X		X			3/8" (Qty of Three) x 1/2"	1/4"				X

DEFINITION OF HOSE TYPE

Deadhead: Non-recirculating

Recirculating: Used to recirculate coatings back to the supply tanks from the mix manifold

Modified: For coupling to another modified hose

Moisture-Lock: Used for moisture-sensitive coatings

OPTIONAL ACCESSORIES

Part Numbers	7250 PSI HEATED HOSE BUNDLES									
	Deadhead	Recirculating	Modified	Moisture-Lock	Airless Spray Hose I.D.	Solvent Hose I.D.	Length			
							50 Ft.	100 Ft.	150 Ft.	200 Ft.
20100272	X				1/4" x 3/8" x 1/2"	1/4"	X			
20100258	X				1/4" x 3/8" x 1/2"	1/4"		X		
20100226	X				1/4" x 3/8" x 1/2"	1/4"			X	
20100450	X				1/4" x 3/8" x 1/2"	1/4"				X
20101075	X		X		1/4" x 3/8" x 1/2"	1/4"	X			
20101077	X		X		1/4" x 3/8" x 1/2"	1/4"		X		
20100451		X			1/4" (Qty of 3) x 3/8" x 1/2"	1/4"	X			
20100452		X			1/4" x 3/8" (Qty of 3) x 1/2"	1/4"		X		
20100453		X			1/4" (Qty of 3) x 3/8" x 1/2"	1/4"			X	
20100454		X			1/4" (Qty of 3) x 3/8" x 1/2"	1/4"				X
20100939		X	X		3/8" (Qty of 3) x 1/2"	1/4"		X		
20100466				X	1/4" x 3/8" x 1/4"	1/4"	X			
20100467				X	1/4" x 3/8" x 1/4"	1/4"		X		
20100468				X	1/4" x 3/8" x 1/4"	1/4"			X	
20100469				X	1/4" x 3/8" x 1/4"	1/4"				X

DEFINITION OF HOSE TYPE

Deadhead: Non-recirculating

Recirculating: Used to recirculate coatings back to the supply tanks from the mix manifold

Modified: For coupling to another modified hose

Moisture-Lock: Used for moisture-sensitive coatings

GLOBAL HEADQUARTERS

- 3425 East Locust Street
Davenport, IA 52803

ph: 800.BLAST.IT (800.252.7848)
ph: 563.324.2519
fax: 563.324.6258

REGIONAL BRANCH OFFICES

- **Iowa**
Davenport
- **Louisiana**
Gonzales
Harvey
Lafayette
- **Ohio**
Youngstown
- **Texas**
Beaumont
Corpus Christi
Deer Park



ABRASIVES
BLASTING
COATING
DUST COLLECTORS
ENGINEERED SYSTEMS
RENTAL
SAFETY
SERVICE, REPAIR, & MODERNIZATION
VACUUMS

40+ NATIONWIDE SHIPPING LOCATIONS



★ Marco Regional Branch Offices and Shipping Locations ● Direct Shipping Locations

CONTACT MARCO

800.BLAST.IT
(800.252.7848)
563.324.2519
FAX: 563.324.6258

WWW.MARCO.US
SALES@MARCO.US